



## SENATE BILL 844, ADULT LOCAL CRIMINAL JUSTICE FACILITIES CONSTRUCTION FINANCING PROGRAM PROPOSAL FORM

*This document is not to be reformatted.*

### SECTION 1: PROJECT INFORMATION

A. APPLICANT INFORMATION AND PROPOSAL TYPE				
COUNTY NAME San Joaquin County		STATE FINANCING REQUESTED \$ 7,672,000.00		
SMALL COUNTY (Below 200,000 GENERAL COUNTY POPULATION) <input type="checkbox"/>	MEDIUM COUNTY (200,000 - 700,000 GENERAL COUNTY POPULATION) <input type="checkbox"/>	LARGE COUNTY (700,001 + GENERAL COUNTY POPULATION) <input checked="" type="checkbox"/>		
TYPE OF PROPOSAL – INDIVIDUAL COUNTY FACILITY /REGIONAL FACILITY PLEASE CHECK ONE (ONLY):				
INDIVIDUAL COUNTY FACILITY <input checked="" type="checkbox"/>		REGIONAL FACILITY <input type="checkbox"/>		
B: BRIEF PROJECT DESCRIPTION				
FACILITY NAME San Joaquin County Detention and Program Facility – Mental Health Treatment Housing Unit				
PROJECT DESCRIPTION Medical/mental health housing and treatment and program space for intensive, evidence-based, in-custody treatment and programming for sentenced and pre-sentenced local offenders.				
STREET ADDRESS 7000 Michael N. Canlis Boulevard				
CITY French Camp		STATE CA	ZIP CODE 95231	
C. SCOPE OF WORK – INDICATE FACILITY TYPE <u>AND</u> CHECK ALL BOXES THAT APPLY.				
FACILITY TYPE (II, III or IV) II	<input checked="" type="checkbox"/> NEW STAND-ALONE FACILITY	<input type="checkbox"/> RENOVATION/ REMODELING	<input checked="" type="checkbox"/> CONSTRUCTING BEDS OR OTHER SPACE AT EXISTING FACILITY	
D. BEDS CONSTRUCTED – Provide the number of BSCC-rated beds and non-rated special use beds that will be subject to construction as a result of the project, <u>whether remodel/renovation or new construction.</u>				
	A. MINIMUM SECURITY BEDS	B. MEDIUM SECURITY BEDS	C. MAXIMUM SECURITY BEDS	D. SPECIAL USE BEDS
Number of beds constructed, remodeled				32
TOTAL BEDS (A+B+C+D)	32	E. BEDS REMOVED/ DECOMMISSIONED		F. NET BEDS AFTER COMPLETED PROJECT
		32 Existing Honor Farm Barracks		0 (further reduction of rated beds through SB1022 project)

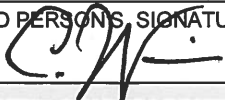
<b>E. APPLICANT'S AGREEMENT</b>			
By signing this application, the authorized person assures that: a) the County will abide by the laws, regulations, policies, and procedures governing this financing program; and, b) certifies that the information contained in this proposal form, budget, narrative, and attachments is true and correct to the best of his/her knowledge.			
<b>PERSON AUTHORIZED TO SIGN AGREEMENT</b>			
NAME Charles Winn		TITLE Chair, Board of Supervisors	
AUTHORIZED PERSON'S SIGNATURE 		DATE	2/22/17
<b>F. DESIGNATED COUNTY CONSTRUCTION ADMINISTRATOR</b>			
This person shall be responsible to oversee construction and administer the state/county agreements. (Must be county staff, not a consultant or contractor, and must be identified in the Board of Supervisors' resolution.)			
<b>COUNTY CONSTRUCTION ADMINISTRATOR</b>			
NAME Marcia Cunningham		TITLE Director, General Services	
DEPARTMENT General Services Department		TELEPHONE NUMBER 209-468-3664	
STREET ADDRESS 44 North San Joaquin Street, Suite 590			
CITY Stockton	STATE CA	ZIP CODE 95202	E-MAIL ADDRESS mcunningham@sjgov.org
<b>G. DESIGNATED PROJECT FINANCIAL OFFICER</b>			
This person is responsible for all financial and accounting project related activities. (Must be county staff, not a consultant or contractor, and must be identified in the Board of Supervisors' resolution.)			
<b>PROJECT FINANCIAL OFFICER</b>			
NAME Sandra Regalo		TITLE Senior Deputy County Administrator	
DEPARTMENT County Administrator's Office		TELEPHONE NUMBER 209-468-3417	
STREET ADDRESS 44 North San Joaquin Street, Suite 640			
CITY Stockton	STATE CA	ZIP CODE 95202	E-MAIL ADDRESS sregalo@sjgov.org
<b>H. DESIGNATED PROJECT CONTACT PERSON</b>			
This person is responsible for project coordination and day-to-day liaison work with the BSCC. (Must be county staff, not a consultant or contractor, and must be identified in the Board of Supervisors' resolution.)			
<b>PROJECT CONTACT PERSON</b>			
NAME Michael Tibon		TITLE Correctional Lieutenant	
DEPARTMENT Sheriff's Office		TELEPHONE NUMBER 209-938-9949	
STREET ADDRESS 7000 Michael N. Canlis Boulevard			
CITY French Camp	STATE CA	ZIP CODE 95231	E-MAIL ADDRESS mtibon@sjgov.org

## SECTION 2: BUDGET SUMMARY

### Budget Summary Instructions

**(This must be part of the 35 page narrative)** Definitions of total project costs for purposes of this program (state reimbursed, county cash contribution, and county in-kind contribution) can be found in the “Budget Considerations” page 22 of the Senate Bill (SB) 844, Construction of Adult Local Criminal Justice Facilities (ALCJF’s) Request for Proposals (RFP). The county cash and in-kind contributions are collectively the county contribution. Those defined costs in the RFP shall be the guide for accurately completing this budget summary section.

In the Budget Summary Table that follows in part D of this section, indicate the amount of state financing requested and the amount of cash and/or in-kind contributions allotted to each budget line-item, in total defining the total project costs. It is necessary to fully include each eligible project cost for state-reimbursed, county cash, and county in-kind contribution amounts.

The in-kind contribution line items represent only county staff salaries and benefits, needs assessment costs, transition planning costs and/or current fair market value of land. An appraisal of land value will only be required after conditional award and only if land value is included as part of the county’s contribution.

The total amount of state financing requested cannot exceed 90 percent of the total project costs. The county contribution must be a minimum of 10 percent of the total project costs (unless the applicant is a small county petitioning for a reduction in the county contribution amount). County contributions can be any combination of cash or in-kind project costs. Small counties requesting a reduction in county contribution must state so in part A of this section. The County contribution must include all costs directly related to the project necessary to complete the design and construction of the proposed project, except for those eligible costs for which state reimbursement is being requested.

State financing limits (maximums) for all county proposals are as follows. For proposed regional ALCJF’s, the size of the lead county determines the maximum amount of funds to be requested for the entire project. In the small county category the lead county may request up to an additional 10% of the maximum amount as an incentive to build a regional facility:

- **\$70,000,000** for large counties;
- **\$30,000,000** for medium counties; and,
- **\$25,000,000** for small counties.

**A. Under 200,000 Population County Petition for Reduction in Contribution**

Counties with a population below 200,000 may petition the Board of State and Community Corrections (BSCC) for a reduction in its county contribution. This proposal document will serve as the petition and the BSCC Board's acceptance of the county's contribution reduction, provided the county abides by all terms and conditions of this SB 844 RFP and Proposal process and receives a conditional award. The county (below 200,000 population) may request to reduce the required match to an amount not less than the total non-state reimbursable projects cost as defined in Title 15, Division 1, Chapter 1, Subchapter 6, Construction Financing Program section 1712.3. If requesting a reduction in match contribution, check the box below to indicate the county's petition.

**By checking this box the county hereby petitions for a contribution reduction request as reflected in the proposal budget.**

**B. Readiness to Proceed Preference**

In order to attest that the county is seeking the readiness to proceed with the proposed project, the county included a Board of Supervisors' resolution doing the following: 1) identifying and authorizing an adequate amount of available matching funds to satisfy the counties' contribution, 2) approving the forms of the project documents deemed necessary, as identified by the board to the BSCC, to effectuate the financing authorized in SB 844 3) and authorizing the appropriate signatory or signatories to execute those documents at the appropriate times. The identified matching funds in the resolution shall be compatible with the state's lease revenue bond financing. Additionally see Section 6 "Board of Supervisors' Resolution" for further instructions.

**This proposal includes a Board of Supervisors' Resolution that is attached and includes language that assures funding is available and compatible with state's lease revenue bond financing. See below for the description of compatible funds.**

County Cash Contribution Funds Are Legal and Authorized. The payment of the county cash contribution funds for the proposed adult local criminal justice facility project (i) is within the power, legal right, and authority of the County; (ii) is legal and will not conflict with or constitute on the part of the County a material violation of, a material breach of, a material default under, or result in the creation or imposition of any lien, charge, restriction, or encumbrance upon any property of the County under the provisions of any charter instrument, bylaw, indenture, mortgage, deed of trust, pledge, note, lease, loan, installment sale agreement, contract, or other material agreement or instrument to which the County is a party or by which the County or its properties or funds are otherwise subject or bound, decree, or demand of any court or governmental agency or body having jurisdiction over the County or any of its activities, properties or funds; and (iii) have been duly authorized by all necessary and appropriate action on the part of the governing body of the County.

No Prior Pledge. The county cash contribution funds and the Project are not and will not be mortgaged, pledged, or hypothecated by the County in any manner or for any purpose and have not been and will not be the subject of a grant of a security interest by the County. In addition, the county cash contribution funds and the

Project are not and will not be mortgaged, pledged, or hypothecated for the benefit of the County or its creditors in any manner or for any purpose and have not been and will not be the subject of a grant of a security interest in favor of the County or its creditors. The County shall not in any manner impair, impede or challenge the security, rights and benefits of the owners of any lease-revenue bonds sold by the State Public Works Board for the Project (the "Bonds") or the trustee for the Bonds.

Authorization to Proceed with the Project. The Project proposed in the County's SB 844 Financing Program proposal is authorized to proceed in its entirety when and if state financing is awarded for the Project within the SB 844 Financing Program.

**C. California Environmental Quality Act (CEQA) compliance**

Has the county completed the CEQA compliance for the project site?

**Yes. If so, include documentation evidencing the completion (preference points).**

**No. If no, describe the status of the CEQA certification.**

**D. Agreement Not to Lease Beds if Increasing County Capacity**

If the proposed project results in a net increase in rated beds in the county, will the county certify and covenant in writing that the county will not lease housing capacity from the proposed SB 844 project to any other public or private entities for a period of 10 years beyond the completion date of the adult local criminal justice facility?

**Yes. The County agrees that if the project results in a net increase in rated beds, the County will not lease capacity in the SB 844 financed adult local criminal justice facility to any other public or private entity for a period of 10 years beyond the completion date of the adult local criminal justice facility. The County further agrees to certify and covenant in writing to this requirement in future agreements as provided by the BSCC and/or SPWB.**

**No. (Project not eligible for SB844 funding)**

**E. Budget Summary Table (Report to Nearest \$1,000)**

LINE ITEM	STATE REIMBURSED	CASH CONTRIBUTION	IN-KIND CONTRIBUTION	TOTAL
1. Construction	\$ 7,672,000	\$ 0		\$ 7,672,000
2. Additional Eligible Costs*	\$ 0	\$ 26,000		\$ 26,000
3. Architectural	\$ 0	\$ 569,000		\$ 569,000
4. Project/Construction Management	\$ 0	\$ 50,000		\$ 50,000
5. CEQA	\$ 0	\$ 0		\$ 0
6. State Agency Fees**	\$ 0	\$ 20,000		\$ 20,000
7. Audit		\$ 0	\$ 5,000	\$ 5,000
8. Needs Assessment		\$ 48,000	\$ 0	\$ 48,000
9. Transition Planning		\$ 0	\$ 100,000	\$ 100,000
10. County Administration			\$ 50,000	\$ 50,000
11. Land Value			\$ 0	\$ 0
<b>TOTAL PROJECT COSTS</b>	<b>\$ 7,672,000</b>	<b>\$ 713,000</b>	<b>\$ 155,000</b>	<b>\$ 8,540,000</b>
<b>PERCENT OF TOTAL</b>	<b>89.84%</b>	<b>8.35%</b>	<b>1.81%</b>	<b>100.00 %</b>

\* Additional Eligible Costs: This line item is limited to specified fees and moveable equipment and moveable furnishings (eligible for state reimbursement or cash contribution), and public art (eligible for cash contribution only)

\*\* For State Agency Fees: State reimbursable costs include Real Estate Due Diligence only. State Fire Marshal fees may only be claimed as cash match.

Provide an explanation below of how the dollar figures were determined for each of the budget categories above that contain dollar amounts. Every cash contribution (match) line item shall be included with a reporting of the full amount budgeted unless a line item is not an actual cash contribution project cost for the county. (In that case, indicate so below.) For each budget category explanation below, include how state financing and the county contribution dollar amounts have been determined and calculated (be specific).

1. **Construction (includes fixed equipment and furnishings) (state reimbursement/cash match):** Cost estimate performed on anticipated scope with conceptual design, current similar projects, escalated to midpoint of construction, and construction contingency, assuming construction concurrent with SB1022 Detention and Program Facility Project: \$7,672,000
2. **Additional Eligible Costs (specified allowable fees, moveable equipment and furnishings, and public art)**
  - a) **Define each allowable fee types and the cost of each:** Costs for County Plan Check Fees; \$26,000.00.

- b) **Moveable equipment and moveable furnishings total amount:** \$0.00 County will relocate some existing equipment and furnishings, cash match potential additional items.
- c) **Public art total amount:** \$0.00

**3. Architectural(state reimbursement/cash match):**

- a) **Describe the county's current stage in the architectural process:** County is currently working with Architectural firm to determine program spaces, develop conceptual design, and estimate probable construction costs.
- b) **Given the approval requirements of the State Public Works Board (SPWB) and associated state reimbursement parameters (see "State Lease Revenue Bond Financing" section in the RFP), define which portions/phases of the architectural services the county intends to seek state dollar reimbursement:** None (\$0.00)
- c) **Define the budgeted amount for what is described in b) above:** \$0.00
- d) **Define which portion/phases of the architectural services the county intends to cover with county contribution dollars:** All phases of design process. The County will fund the entire architectural fees with cash match and understand the ability to better control schedule outcome with not be seeking State reimbursement for fees. This will allow the County and design teams to continue work without waiting for full approval of prior phases, and concurrent with SB 1022 project for economy of scale.

**Define the budgeted amount for what is described in d) above:** \$569,000

- 4. **Project/Construction Management - Describe which portions/phases of the construction management services the county intends to claim as:**
  - a) **Cash** \$50,000
  - b) **In-Kind** \$0.00
- 5. **CEQA – may be state reimbursement (consultant or contractor) or cash match** CEQA was completed as part of the SB1022 project and on the same site. \$0.00
- 6. **State Agency Fees – Counties should consider approximate costs for the SFM review which may be county cash contribution (match). \$16,000 for the due diligence costs which may be county cash contribution (match) or state reimbursement.** The County has budgeted (prorated amount) for SFM plan reviews since they will be concurrent with SB1022 project plan reviews and one project set of plans (which is similar to another recent combined LRBF project and accepted direction). \$20,000 Due diligence costs shall be carried by the SB1022 project since using for in-kind on that funding award and not for SB844.
- 7. **Audit of Grant - Define whether the county is intending to use independent county auditor (in-kind) or services of contracted auditor (cash) and amount budgeted:** The County will perform the audit as In-Kind Contribution. \$5,000
- 8. **Needs Assessment - Define work performed by county staff (in-kind), define hired contracted staff services specifically for the development of the needs assessment (cash match) :** Cash match for Needs Assessment update . \$48,000

9. **Transition Planning – Define work performed by county staff (in-kind), define the staff hired specifically for the proposed project (cash match):** Sheriff's Office staff will work on Transition Planning will be In-Kind Contribution. \$100,000
10. **County Administration – Define the county staff salaries/benefits directly associated with the proposed project.** Additional County Administration time for the SB 844 project to supplement the effort required for the SB1022 project. In-Kind Contribution. \$50,000
11. **Site Acquisition - Describe the cost or current fair market value (in-kind):** There are no additional site acquisition costs beyond those assigned to the SB1022 project. County will not utilize site value for in-kind match on SB844.



## SECTION 3: PROJECT TIMETABLE

Prior to completing this timetable, the county must consult with all appropriate county staff (e.g., county counsel, general services, public works, county administrator) to ensure that dates are achievable. Please consult the “State Public Works Board (State Capital Outlay Process)/Board of State and Community Corrections Processes and Requirements” section, page 30 of the RFP for further information. Complete the table below indicating start and completion dates for each key event, including comments if desired. Note the required time frames for specific milestone activities in this process. The BSCC Board intends to make conditional awards at its June 2017 board meeting.

KEY EVENTS	START DATES	COMPLETION DATES	COMMENTS
Site assurance/comparable long-term possession <u>within 90 days of award</u>	6/14/2017	10/13/2017	Can be concurrent with SB1022 project.
Real estate due diligence package submitted <u>within 120 days of award</u>	6/14/2017	11/3/2017	Site value will not be utilized for In-Kind match on SB844 since used for SB1022
SPWB meeting – Project established <u>within 18 months of award</u>	6/14/2017	11/9/2017	Accommodate SPWB agenda/review period.
Schematic Design with Operational Program Statement <u>within 24 months of award</u> (design-bid-build projects)	8/11/2017	11/16/2017	Submit similar time as SPWB for Project Establishment and all cash match for A/E services
Performance criteria with Operational Program Statement <u>within 30 months of award</u> (design-build projects)			
Design Development (preliminary drawings) with Staffing Plan	11/20/2017	3/14/2018	Continue with DD’s since using cash match for A/E services. Ground Lease during DD’s or start of CD’s.
Staffing/Operating Cost Analysis approved by the Board of Supervisors	12/20/2017	6/15/2018	Anticipated operating costs already started with BOS.
Construction Documents (working drawings)	3/15/2018	1/15/2019	Continue with DD’s since using cash match for A/E services. Additional time allocated for agreements, SFM and BSCC reviews.

- REDACTED -

Construction Bids or Design-Build Solicitation	1/18/2019	3/21/2019	
Notice to Proceed <u>within 42 months of award</u>	3/29/2019	5/21/2019	State process for review and approval of bids
Construction (maximum three years to complete)	5/21/2019	8/20/2020	Anticipating a 15 month construction period.
Staffing/Occupancy <u>within 90 days of completion</u>	8/20/2020	10/15/2020	

## SECTION 4: FACT SHEET

To capture key information from Section 5: Narrative, applicants must complete this Fact Sheet. Minimal information is requested. Narrative information or explanations are not to be included on this Fact Sheet nor as part of the tables in this section. Explanations of what is provided in these tables may be included in the Narrative section of the Proposal Form. Proposal narratives may include reference back to one or more of these specific tables (e.g., refer to Table 3 in Section 4 Fact Sheet).

**Table 1: Provide the following information**

1.	County general population	726,106
2.	Number of detention facilities	2
3.	BSCC-rated capacity of jail system (multiple facilities)	1665
4.	ADP (Secure Detention) of system	1216
5.	ADP (Alternatives to Detention) of system	97
6.	Percentage felony inmates of system	48%
7.	Percentage non-sentenced inmates of system (this is not for the pretrial information that is requested in the rating criteria Section 5)	63%
8.	Arrests per month	560
9.	Bookings per month of system	1828
10.	“Lack of Space” releases per month	73

**Table 2: Provide the name, BSCC-rated capacity (RC) and ADP of the adult detention facilities (type II, III, and IV) in your jurisdiction (county)**

	Facility Name	RC	ADP
1.	John J. Zunino Detention Facility (Type II Facility)	1195	930
2.	San Joaquin County Honor Farm (Type II Facility)	470	286
3.			
4.			
5.			
6.			
7.			
8.			

<b>Table 3: List of the offender assessments used for determining programming</b>		
<b>Assessment tools</b>		<b>Assessments per Month</b>
1.	Education Assessment/CASAS	34
2.	ARCCS Grant Assessment	60
3.	Classification Assessment	ALL
4.		
5.		
6.		

## SECTION 5: NARRATIVE

Section 5 is limited to 35 pages (the budget narrative from Section 2 must be included in the 35 page limit) and must be double-spaced with one-inch margins. All narrative (Section 5) must use no smaller than 12-point Arial font and be ordered in the 6 subject areas listed below. If the narrative can be written in less than the maximum 35 pages, please do so (avoid “filler”). Pictures, charts, illustrations, or diagrams are encouraged in the narrative. Data sources must be identified.

If the project is for a regional ALCJF (must meet the requirements outlined in the “Eligible Projects” section, “Limit on Number of Projects/Set Asides” (pages 9 and 10) section of the RFP), clearly indicate so. Include the names of the partnering counties and their individual data that support the project and respond to the requested narrative points.

In order for a proposal to be able to compete and be rated by the ESC, it must include the following:

- Any locked facility constructed or renovated with state funding awarded under this program shall include space to provide onsite, in-person visitation capable of meeting or surpassing the minimum number of weekly visits required by state regulations for persons detained in the facility. (Gov. Code § 15820.946 subd. (f))
- Any county applying for financing authority under this program shall include a description of efforts to address sexual abuse in its adult local criminal justice facility constructed or renovated. (Gov. Code § 15820.946 subd. (g))

The Proposal structure is designed to allow county applicants to demonstrate how their proposed project meets the need for ALCJFs as stated in SB 844, and how proposed expenditures of public funds meet the identified need and are justified. The presentation of information about the proposed project should allow both applicants and raters to make a step-by-step connection between the need addressed by the project and its associated budget request.

The raters will ask many questions about the proposed project as they evaluate, including but not limited to:

- What need is the project designed to meet?
- What construction work does the county propose is necessary to meet this need?
- How will offender programming and/or treatment be served in the proposed new or renovated facility?
- What is the county plan of action to accomplish the legal, design, and build steps required for this project?
- What is the total project cost, what are the funding sources, and how will the county allocate expenditures of these funds?

- Will the county be prepared to proceed with the project in a timely manner if financing is approved?

SB 844 describes the purpose for which ALCFJ construction financing is to be awarded. Additionally, the legislation states specific factors to be considered in assessing how well a proposal suits those purposes. In each section of the proposal, the rater (1) assesses how well the narrative addresses the general merit factors that apply to this section, and (2) assesses special factors mentioned in the SB 844 legislation as criteria for funding.

- a. General merit is assessed on a 13-point scale:
  - 0 Fails to meet minimum standards for financing
  - 1-3 Reaches minimum standards despite deficiencies
  - 4-6 Generally adequate
  - 7-9 Good
  - 10-12 Excellent
- b. Special merit factors are scored from 0 to 4; depending on the factor, it may be scored on a 0-4 range, or as yes/no (0/4).

For an ALCJF construction project, county applicants must answer the following questions:

- 1. Statement of Need: What are the safety, efficiency, and offender programming and/or treatment needs addressed by this construction proposal? Please cite findings from the needs assessment (through 2019) submitted with this proposal.**

General Merit Factors

- A. To what extent does the need described in the proposal match the legislative intent of SB844?
- B. Does the applicant provide a compelling case for the use of state financing to meet this need?
- C. How well is the description of need supported by evidence provided by the applicant?

- 2. Scope of Work: Describe the areas, if any, of the current facility to be replaced or renovated, and the nature of the renovation, including the number of cells, offices, classrooms or other programming/treatment spaces to be replaced or added and the basic design of the new or renovated units.**

General Merit Factors:

- A. How will the planned replacement, renovation, or new construction meet the needs described in Question 1 (Statement of Need)?
- B. How well does the proposed project plan suit general operational requirements for the type of facility in the proposal, including factors such as safety, security and efficiency?
- C. Where applicable, how well does the proposed project meet specific needs for programming and treatment space?

Special factors (Gov. Code, §15820.946, subd. (c)) Funding consideration:

- A. Does the county plan for seeking to replace compacted, outdated, or unsafe housing capacity that will also add treatment space; or,

- B. Does the county plan for seeking to renovate existing or build new facilities that provide adequate space for the provision of treatment and rehabilitation services, including mental health treatment.

**3. Programming and Services: Describe the programming and/or treatment services currently provided in your facility. Provide the requested data on pretrial inmates and risk-based pretrial release services. Describe the facilities or services to be added as a result of the proposed construction; the objectives of the facilities and services; and the staffing and changes in staffing required to provide the services.**

General Merit Factors:

- A. How clearly described are the facility's current programming and/or treatment services?
- B. If improvements to programming and/or treatment services are expected as a result of the planned construction project:
- Are the improvements to programming and/or treatment services clearly described?
  - How strong is the evidence provided by the applicant that the programming and/or treatment services planned for inmates upon project completion will help reduce recidivism or meet inmates' health and treatment needs while incarcerated?
  - What are the applicant's current efforts and the plan to provide a post-release continuum of care? Describe the applicant's efforts to collaborate with community based partners in this effort.
- C. If improvements are designed to replace compacted, outdated, or unsafe housing capacity:
- How are the program and treatment service needs of the facility population expected or planned to be met?
  - Are the improvements to housing deficiencies clearly described?
  - To what extent will the deficiencies be remedied by the proposed construction?
- D. How thoroughly does the staffing plan and lines of authority (including interagency partnerships, if relevant) in program and treatment management meet operational objectives?

Special Factors (Gov. Code, § 15820.946, subd. (b)) Mandatory Criterion:

- A. The county provided documentation that states the percentage of its inmates on pretrial status between January 1, 2015 and December 31, 2015 in the narrative of question 3.
- B. Provided a description of the county risk-assessment-based pretrial release program is provided in the narrative of question 3.

**4. Administrative Work Plan: Describe the steps required to accomplish this project. Include a project schedule, list the division/offices including personnel that will be responsible for each phase of the project, and how it will be coordinated among responsible officials both internally and externally.**

General Merit Factors:

- A. How clearly described are the elements of the work plan: timeline, assigned responsibilities, and coordination?
- B. Can the scope of work described in Question 2 (Scope of Work) feasibly be accomplished within the time allotted?

**5. Budget Narrative: Describe the amounts and types of funding proposed and why each element is required to carry out the proposed project. Describe how the county will meet its funding contribution (match) requirements for all project costs in excess if the amount of state financing requested and how operational costs (including programming costs) for the facility will be sustained.**

General Merit Factors:

- A. Is the allocation of effort in the budget appropriately matched to the objectives described under project need, scope of work, offender treatment and programming, and administrative work plan?
- B. Are the budgeted costs an efficient use of state resources?
- C. Rate the applicant's plan for sustaining operational costs, including programming over the long term.

**6. Readiness to Proceed (Gov. Code, § 15820.946, subd. (b)(2)) Funding Preference:**

- A. Did the county provide a board resolution: 1) authorizing an adequate amount of available matching funds to satisfy the counties' contribution 2) approving the forms of the project documents deemed necessary, as identified by the board (SPWB) to the BSCC, to effectuate the financing authorized by the legislation, 3) authorizing the appropriate signatory or signatories to execute those documents at the appropriate times. The matching funds mentioned in the resolution shall be compatible with the state's lease revenue bond financing. See page 2 of the Proposal Form and Instructions for more information regarding "compatible funds".

Note: Finance and the SPWB will ultimately make the final determination of any fund sources compatibility with the SPWB's lease revenue bond financing. For multi-county proposals or regional proposals, applicants must attach their MOUs. All partners in the regional application must provide a board resolution.

- B. Did the county provide documentation evidencing CEQA compliance has been completed? Documentation of CEQA compliance shall be either a final Notice of Determination or a final Notice of Exemption, as appropriate, and a letter from county counsel certifying the associated statute of limitations has expired and either no challenges were filed or identifying any challenges filed and explaining how they have been resolved in a manner that allows the project to proceed as proposed.



The evaluation factors to be used and the maximum points that will be allocated to each factor are shown in the table below.

EVALUATION FACTOR		Scoring Method	Percentage	Weighted Score
1.	Statement of Need	0-12	15%	18
2.	Scope of Work	0-12	15%	18
	SF A/B: Feasible plan to replace compacted housing/expand program/treatment space	0-4		4
3.	Programming and Services	0-12	25%	30
	SF A: Documents pretrial inmate percentage	0/4		4
	SF B: Describes risk assessment-based pretrial release process	0/4		4
4.	Administrative Work Plan	0-12	10%	12
5.	Budget Narrative	0-12	10%	12
6.	A. Readiness: Board Resolution	0/12	10%	12
	B. Readiness: CEQA Compliance	0/12	15%	18
<b>TOTAL POINTS</b>		<b>96</b>	<b>100%</b>	<b>132</b>

Notes:

SF                      Special Factor  
 0-12                  Scored on a 0 to 12 pt. range  
 0-4                    Scored on a 0 to 4 pt. range  
 0/4                    Scored 4 if pass, 0 if fail  
 0/12                   Scored 12 if pass, 0 if fail

## SECTION 6: BOARD OF SUPERVISORS' RESOLUTION

All counties applying for SB 844 financing must include a Board of Supervisors' resolution with the proposal submittal. The resolution must include the requisite components as outlined below. For counties submitting multiple proposals (which requires participation in a regional ALCJF as described in the RFP), separate resolutions for each proposal, with the necessary language contained in each resolution, are required.

**The Board of Supervisors' resolution for the project shall be attached to the original proposal and must contain all of the following:**

- A. Names, titles, and positions of county construction administrator, project financial officer, and project contact person.
- B. Approving the forms of the project documents deemed necessary, as identified by the board (SPBW) to the BSCC, to effectuate the financing authorized by the legislation.
- C. Authorization of appropriate county official to sign the applicant's Agreement and submit the proposal for funding.
- D. Assurance that the county will adhere to state requirements and terms of the agreements between the county, the BSCC, and the SPWB in the expenditure of state financing and county match funds.
- E. Assurance that authorizes an adequate amount of available matching funds to satisfy the counties' contribution. The identified matching funds in the resolution shall be compatible with the states' lease revenue bond financing. (see page 2 of this form for description of compatible funds)
- F. Assurance that the county will fully and safely staff and operate the facility that is being constructed (consistent with Title 15, California Code of Regulations, Chapter 1, Subchapter 6 section 1756 (j) 5) within 90 days after project completion.
- G. All projects shall provide the following site assurance for the county facility at the time of proposal or not later than 90 days following the BSCC's notice of Intent to Award: 1) assurance that the county has project site control through either fee simple ownership of the site or comparable long-term possession of the site and right of access to the project sufficient to assure undisturbed use and possession of the site; and, 2) will not dispose of, modify the use of, or change the terms of the real property title, or other interest in the site of facility subject to construction, or lease the facility for operation to other entities, without permission and instructions from the BSCC, for so long as the SPWB lease-revenue bonds secured by the financed project remain outstanding.
- H. Attestation to \$\_\_\_\_\_ as the current fair market land value for the proposed new or expanded facility. This can be claimed for on-site land value for new facility construction, on-site land value of a closed facility that will be renovated and reopened, or on-site land value used for expansion of an existing facility. It cannot be

claimed for land value under an existing operational facility. (If claimed as in-kind match, actual on-site land value documentation from an independent appraisal will be required as a pre-agreement condition.)

- I. Regional ALCJF projects only: A Board of Supervisors' resolution from all counties in the regional partnership containing the items identified above, along with a Memorandum of Understanding (MOU) or Joint Powers Agreement (JPA) between each of the partner counties. Please consider the information about regional ALCJFs for the purposes of this funding program as described in the "Eligible Projects" section, "Limit on Number of Projects/Set Asides" sub-section of the RFP, before developing these documents. If preliminary MOUs and JPAs are submitted, final documents must be submitted within 90 days following the notification to the lead county of conditional Intent to Award state financing.

Note: Additionally, refer to "Section 5: Narrative - Readiness to Proceed."

## PROPOSAL CHECKLIST

- a. Page 1 of the Proposal Form is the first page of your proposal. Please use standard copy paper. Do not use heavyweight, card stock, or glossy paper. Covers, table of contents, introductory letters, tabs, or dividers are not allowed.
- b. The formal proposal includes the Proposal Form, narrative, and required attachments (needs assessment, board resolution, regional project MOU's or JPA's, one (1) additional attachment with a limit of 4 pages of schematics, graphs or charts) as a combined document.
- c. Provide one original proposal with Applicants Agreement signed by proper authority on page 2 section E.
- d. In addition to the wet signature original and 1 electronic copy (read only). The electronic version should be an Adobe Acrobat file (pdf) on a standard CD ROM.
- e. Two whole punch the top of the original copy of the proposal.
- f. Use a clip to secure the proposals. (Do not put proposals in binders or use staples.)
- g. The Arial font used for the proposal and the appendices can be no smaller than 12 point.
- h. The narrative for Sections 5 must be double-spaced with one-inch margins.
- i. The entire narrative (Section 5 and Section 2) cannot exceed 35 pages.
- j. The only attachments are the board resolution, needs assessment, regional project MOU's and JPA's, and one (1) attachment with a limit of four (4) pages of schematics, graphs or charts.
- k. Attach to the original proposal the Board of Supervisors' resolution (original or copy), fully executed, containing the language cited in Section 6 of the Proposal Form. Please include an additional copy of the resolution.
- l. Provide one copy of a needs assessment study (as described previously in the RFP) if the county intends to build a new facility or add bed space to an existing facility. Projects for renovation and program space only are not required to submit a separate needs assessment study but are required to comprehensively document the need for the project in the proposal.
- m. For regional ALCJFs, provide one copy of the MOU or JPA and the Board of Supervisors' resolution from all participating counties.

## 1: STATEMENT OF NEED

**What are the safety, efficiency, and offender programming and/or treatment needs addressed by this construction proposal? Please cite findings from the needs assessment (through 2019) submitted with this proposal.**

The San Joaquin County Sheriff's Office (SJSO) previously applied for SB 1022 funding and received a conditional partial award in the amount of \$33.3M of the \$40M requested. This award was subsequently rescinded due to an appeal won by Stanislaus County. Additionally, San Joaquin County submitted for SB 863 funding but was unsuccessful in receiving an award. More recently, the County was conditionally awarded \$32.3M in SB 1022 funds (\$40M was requested) as a result of another county relinquishing its funds. The County intends to use its SB 1022 award to construct a medium security level facility to replace the antiquated and unsafe minimum security Honor Farm originally built in 1949. This new facility will consist of four 64-bed dormitory style housing units, and multiple programmatic classrooms affording a variety of treatment, academic, and vocational programs, as well as outdoor recreation and in-person visitation facilities.

San Joaquin County is applying for SB 844 funding to support construction of a dedicated Mental Health Treatment Housing Unit (MHTHU) consisting of 32 single occupancy beds with program and treatment space. SB 844 funding will provide the funds needed to supplement the SB 1022 partial award in order to replace the Honor Farm with a new modern, safe, secure, and *program-focused* mental health and re-entry. The County proposes the SB 844 MHTHU as an extension to its conditionally awarded SB

1022 Base Project. The Unit is designed to be directly adjacent to the SB 1022 project to share resources, medical services, and program spaces. The SJSO envisions a facility that provides much needed mental healthcare, treatment, and programming while providing an updated design to create a safer environment for detainees and staff alike. This new comprehensive facility will help alleviate the classification issues and provide detainees with the programming and services needed for successful re-entry into the community. The new facility will have the ability to house multiple inmate classifications and, most importantly, provide designated program and treatment spaces.

**Appropriate Beds Required:** The Needs Assessment prepared for the County identifies a requirement for a new type of medium security housing and 30 desperately needed behavioral health beds. The addition of podular designed medium security dormitory units and a therapeutic medical/mental health treatment housing unit would support the main jail in accommodating inmate classifications and provide inmates access to much-needed healthcare and programming services. It is important to note that the *total* number of combined beds in the proposed SB 844 and SB 1022 facility would be *less* than the current rated bed capacity of the Honor Farm Facility.

The SB 1022 base project is a 256 bed medium security replacement facility that would provide programming re-entry/re-integration services consisting of housing units with small dormitory style grouped housing units, healthcare treatment pods, and large academic and vocational program areas – all within a secure perimeter. The inclusion of the MTHU will allow the SJSO to take a meaningful and significant step forward in providing proper treatment and care for the mentally ill offender. As identified by the Needs Assessment, the current number of mental health beds is notably lacking due to

the amount of arrestees requiring this type of housing. Currently, the Main Jail has a total of only four safety cells (one in the medical unit and three in booking) and *only eight* designated mental health beds, which are located in the medical unit. The County's Sheltered Housing Unit is currently utilized to manage the over flow of mentally ill offenders who necessitate closer monitoring. This arrangement simply does not meet the needs of the mentally ill currently housed in the existing jail. Additionally, utilizing the Sheltered Housing Unit as a relief valve significantly reduces the number of beds required for medical patients.

**Identified Need:** The identified need is to add housing units to the medium level of security between the general population and administrative segregation. This new facility will help alleviate the classification issues that currently exist at the Honor Farm and will provide the type of programming and services needed by the mentally ill offender to successfully re-enter the community.

The Main Jail and Honor Farm do not have the appropriate beds or programming space for the amount of offenders that need access to mental health services. The County can no longer continue to utilize portions of the Sheltered Housing Unit to meet, much less supplement, the needs of the mentally ill offender. This arrangement is unsafe and generates housing capacity challenges. The MHTHU would provide its own mental health therapeutic programming space to host existing *and new* programs for inmates who are mental health consumers. With treatment and program services being provided in the new housing unit, and the adjacent SB 1022 project, the SJSO will finally be able to provide the mentally ill inmate population the knowledge and skills necessary for successful re-entry into the community.

The classification system is vital to ensuring that the jail is well managed and operates efficiently, effectively, and safely. A relevant classification system is crucial to ensuring security and is fundamental in establishing, programming, staffing, and service requirements. Success is based on identifying inmates who cannot be housed safely in general population because they pose a threat to other inmates, themselves, and/or staff, are targets of victimization, or have specific medical and/or mental health needs. The proposed SB 844 MHTHU will provide housing and treatment for such inmates that are not receiving treatment due to lack of qualified mental health beds. These “at risk” detainees are not receiving the meaningful treatment or the rehabilitation training they need to re-enter the community and reduce the rate of recidivism.

The new MHTHU will provide a safer, more normalized living environment for offenders with a corresponding increase in the delivery of programs and services that target “at risk” offenders. Treatment units will be designed using the Direct Supervision operational philosophy to ensure that staff can interact with offenders, clearly observe offender movement and behavioral conduct, and provide prompt response and resolution to incidents and issues.

While housed at the proposed MHTHU, offenders will be required to participate in extensive programming and treatment services. The SJSO has partnered with the County Office of Education, Friends Outside, the Probation Department, Behavioral Health Services, as well as a host of community based organizations to ensure appropriate programs are offered to participating offenders, as well as to “connect” with in custody offenders to develop the relationships that will carry over when these individuals are released.



The number of inmates with acute medical conditions and mental health disorders that require psychotropic medications has significantly increased for all California county jails in recent years; San Joaquin County is no exception. San Joaquin County Correctional Healthcare has identified that approximately 40% of the inmate population requires some level of mental health services and require specialized housing separate from the general population. This is because they pose a threat to other inmates/staff, are often targets of victimization, and have unique treatment requirements. Further, inmates with physical, mental health and/or substance abuse problems experience greater difficulty with reintegration upon release and typically have poor outcomes with respect to employment, re-offending, and re-incarceration. Providing proper treatment for this group of offenders will significantly improve post-release outcomes.

Jails are often difficult and demanding working environments for all levels of staff: offenders with unrecognized and untreated mental disorders can further complicate and negatively affect the environment while placing even greater demands on staff. Providing appropriate care and housing will create a more rehabilitating environment for inmates and safer working conditions for staff.

SJSO and Correctional Health staff are extremely concerned that merely attempting to medicate and house these individuals alone will not contribute to improving mental health conditions. As such, there is an acknowledged need to have a positive impact on these individuals while incarcerated. The proposed facility will have a two-tiered unit with 32 single occupancy beds dedicated to the treatment of mental health inmates through appropriate housing, extensive treatment space, and outdoor recreation.

**Efforts to address sexual abuse:** It is the policy of the SJSO to maintain a safe environment, free from threats or acts of inmate-on-inmate or staff sexual assault, sexual misconduct, and sexual harassment. The SJSO provides a focus on education, prevention, detection, response, investigation, victim support, and data collection. The department has a zero-tolerance of threats and acts of sexual assault among inmates and any staff sexual misconduct towards inmates. Such acts are strictly prohibited and subject to administrative and criminal disciplinary sanctions.

The SJSO has been proactive in implementing the following to address, prevent, educate, and report sexual abuse:

- The SJSO has instituted the approach outlined above as Departmental Policy.
- All SJSO personnel received six hours of PREA STC certified training with bi-annual updates.
- Sexual abuse video viewing at the time of intake.
- Inmate Housing Hotline number 7732 (PREA)
- “End the Silence” signs in each housing unit throughout all jail facilities.
- PREA pamphlet given to all employees, contractors, vendors and volunteers. Recipients are required to acknowledge and sign a contractual form.
- PREA questions incorporated in Classification Risk Assessment form.
- Inmates are given the following information in the inmate handbook, available in English and Spanish:

What PREA is

Confidentiality

What to do if you are victimized

How to report an incident

Seeking medical help

Understanding the investigative process

Counseling program information

The SJSO is PREA compliant and is currently in the process of becoming PREA certified, which would make the County only the second county in California to be PREA certified.

**In-Person Visitation:** The SJSO has included in-person visitation space within the project to address visitation needs for both SB 1022 and SB 844 projects. This new in-person visitation space will be capable of surpassing the minimum number of weekly visits required by state regulations for persons detained within both projects. The new visitation space will be staffed using current Public Screening Officers currently assigned at the existing Honor Farm visitation.

## 2: SCOPE OF WORK

**Describe the areas, if any, of the current facility to be replaced or renovated, and the nature of the renovation, including the number of cells, offices, classrooms or other programming/treatment spaces to be replaced or added and the basic design of the new or renovated units.**

**SJSO Current Honor Farm:** The San Joaquin County Honor Farm opened in 1949 with portions renovated and minor additions made in 1986 and 1988. The original intended use of this facility was to house sentenced inmates. However, the Honor Farm is currently being operated as Type II housing for both pretrial and sentenced male and female inmates. The aging facility has an outdated design with various dormitory buildings that require continual structural repair and preventative maintenance. The passage of AB 109 has created several challenges to our County jail system and, with limited options at the main jail, the current population of AB 109 inmates placed at the Honor Farm exceeds 100. This results in numerous programming, safety, and security issues. Due to classification and higher security levels, the SJSO is limited to the number of inmates that strictly qualify to be housed at the minimum security Honor Farm. Further the Honor Farm is problematic in safely housing offenders due to its linear design, antiquated systems, and inadequate program space available for treatment.

**SB 1022 Base Project:** San Joaquin County has been conditionally awarded partial SB 1022 funding to replace the Honor Farm Facility. The County intends to use this partial funding to construct a medium level security facility with multiple small dormitory style housing units, classroom settings for a variety of academic and vocational programs, treatment, medical clinic, receiving, administration, in-person visitation, and outdoor recreation – all within a secure perimeter. The Needs Assessment recommends construction of six 64-bed housing units and a 30 mental health beds. With a partially funded award, the SB 1022 Base Project will consist of four 64-bed medium security housing units.

**Proposed SB 844 Project Scope:** The SJSO envisions a specific unit to house only mentally ill offenders. To accomplish this the County is seeking to obtain additional funding through SB 844 to provide the SJSO with a much needed MHTHU. The SB 844 funding amount is only to accommodate the shortfall of SB 1022 partial award. Currently, the main jail has only four safety cells and eight mental health beds to house mental health offenders, with the over flow being housed in sheltered and/or other areas within the main jail. Within the proposed SB 844 project, medical/mental health staff will have access to a private exam clinic in the unit where patients will have complete privacy to discuss their medical/mental health issues. Correctional Health Services (CHS) will provide medical, mental health, and a full scope of related services to all offenders housed in this dedicated unit. Medication delivery will be provided by a trained therapeutic staff member for the continuity and success of the patients. The County believes this will instill trust and compliancy for those patients housed in the MHTHU. The unit will incorporate a therapeutic milieu utilizing evidence based practices, which will enable patients to stabilize and successfully re-enter the community. The space would also have private exam and interview rooms for clinicians and offenders.

The MHTHU will house inmates who will benefit from services currently not being offered in the main jail due to capacity challenges. This housing unit will consist of 32 single occupancy wet cells, two observation cells, two safety cells, an exam room, two interview rooms, a large program room, dedicated outdoor recreation space, a large dayroom with abundance of natural light, and a large work area for mental health and custody staff. This unit will also utilize, and be supplemented by, the four classrooms with

additional programs, service providers, and the in-person visitation area that are incorporated in the SB 1022 Base Project.

### 3: PROGRAMMING AND SERVICES

**Describe the programming and/or treatment services currently provided in your facility. Provide the requested data on pretrial inmates and risk-based pretrial release services. Describe the facilities or services to be added as a result of the proposed construction; the objectives of the facilities and services; and the staffing and changes in staffing required to provide the services.**

**Current Programming/Treatment Services:** The mission of the County's inmate programs and treatment services component is to ensure that inmates are provided actual programs—not just activities, accomplishing this through evidence-based programs. The SJSO understands that providing inmates with the opportunity to learn through a variety of programs and based on educational skills, as well as group and individual counseling will contribute in reducing recidivism. It is the intent that all inmates have access to programs, services, and exercise areas directly from their housing units. This allows for the constructive release of stress resulting from incarceration and provides other meaningful programs which benefit inmates, both in and out of custody.

The majority of programs are conducted at the Honor Farm which contains only two classrooms; the multipurpose room, a visiting room, and the interview room are often utilized as alternative program spaces. This space shortage prohibits the SJSO from offering the number of programs and services that are needed and could be made available. The programs currently offered at the Honor Farm are listed in the table below.

Anger Management	Parenting	Office Technology
Career Development	READ 180	Ownership
Mental Health Group (Violence No More, Tools for Living, Stages for Change, Thinking for a Change)	Correctional Health Support Group	Creative Conflict Resolution
Life Skills	Math	GED/Adult Diploma
52-Week Domestic Violence	Pre-Release	Seeking Safety
ARCC- Re-Entry Co-Curring Offenders Through Collaborative Support	NA-Narcotics Anonymous	Religious Services
Sewing	AA-Alcoholics Anonymous	Gardening

The Main Jail and Honor Farm do not have the appropriate beds or programming space for the amount of offenders who need access to mental health services. Currently, to address the needs of mentally ill offenders the County utilizes portions of the Sheltered Housing Unit, which was not designed for this use and has created housing capacity challenges.

Mental Health Treatment/Programs are currently only available at the Main Jail due to lack of programming space available at the Honor Farm. These types of services are provided for inmates housed in the general population. The unit's lack of programming space creates significant challenges for mental health staff attempting to provide adequate treatment in a general population setting. Mental Health Treatment/Programs currently offered at the Main Jail are listed in the table below.

<b>MENTAL HEALTH TREATMENT PROGRAMS</b>			
<b>Type of Program</b>	<b>Schedule</b>	<b>Type of Program</b>	<b>Schedule</b>
Psychiatric Services	Daily	Post-Partum Depression Screens	Point of Booking or need identified
Individual Therapy	Daily-Weekly	Suicidal Risk Screens, Assessments and Follow Ups	Daily

Group Therapy (GT)	Weekly	Collaboration with BHS, State Hospitals, Superior Court, VMRC, CBO's, etc.	Daily
Seeking Safety (GT)	Weekly	Rep. in Dept. 25 (MH Court), Veteran's Treatment Court, Parole Re-Entry, Compliance Court, AB109 Court & DUI Court	Weekly
Thinking for Change (GT)	Weekly	Liaison for Family Members	Daily
Violence No More (GT)	Weekly	Honor Farm Mental Health Clinic	Daily, Specialty MH Clinic 2 days per week
Tools for Living (GT)	Weekly	MFT Practicum Site for Graduate Students	Daily
Stages for Change (GT)	Weekly	MSW Practicum Site for Graduate Students	Daily
Crisis Management	Daily	LPCC Practicum Site for Graduate Students	Daily
Discharge Planning	Daily	Collaboration with Homeless Outreach Worker	As Needed
Warm Hand-Offs with Agencies in the Community & BHS	Daily	AB109 Mental Health Specialist	Daily
Veteran's Outreach	Bi-Weekly	Measurement Tool Utilized – Becks for Anxiety, Becks for Depression, PHQ9, PTSD for Civilians & Military	Completed as Part of Mental Health Assessment
1170.9 & 4011.6 Completions	As Ordered by Superior Court	Point of Booking if meets criteria or Nurse Assessment	Daily
ASI & ASAM Completions	As Ordered by Superior Court	PHF or CS (Crisis Stabilization Unit) Admission	As Needed

**Planned Improvements to Programming/Mental Health Treatment Services:**

By contrast, the SB 1022 base project and proposed additional SB 844 projects would provide program space to support programming and education opportunities for the *entire* offender population of the new facility. The SJSO would greatly benefit from having specific program and educational areas to implement even more evidence-based programs. The successful outcome of the evidence-based programs that are provided



will contribute in reducing the risk to re-offend. The offender will be evaluated during and following these programs to assist them in reaching a successful completion.

The SJSO collaborates with many county and community based agencies to offer a wide range of effective programs. The programs will be substantially expanded when the added program space becomes available. The proposed SB 844 MHTHU will have dedicated programming space, a recreation yard, and will be supplemented by the SB 1022 classrooms, an in-person visitation space, and the medical clinic. The SB 1022 Base Project will have four large classrooms, a centralized medical clinic, in-person visitation, and a medical exam room in each housing unit. The combined projects meet an overwhelming need for programming and treatment space by offering programs to a wider range of inmate classifications. The new programming space will allow expanded services and provide a more effective evidenced based/cognitive behavioral approach to programming as well as additional vocational training programs. The combination of evidence based programs, employment, vocational, and re-entry programs are particularly aimed at reducing recidivism and helping with transition to a successful reintegration into the community and, in this way, reducing further demand on jail bed needs.

A specialized MHTHU is imperative to the stabilization of incarcerated individuals identified with acute mental illnesses. The current operational procedure related to classification of individuals presents an internal challenge when providing mental health treatment. The custody's classification team evaluates inmates every 30 days for those identified as general population and will transfer them from their current housing to another unit of the jail within 90 days. Specific mental health services that are provided in

one unit are currently not duplicated in every unit of the jail facility. This presents as a huge obstacle when meeting the identified clinical objectives of the inmate's treatment plan. A specialized MHTHU would allow the mental health clinicians to better monitor, observe, and interact at a higher level than what currently takes place because of the lack of mental health treatment beds, specialized programming, and support areas. It will also provide the ability for inmates to achieve their clinical goals. Research has indicated that disruption of mental health services greatly contributes to the overall emotional de-compensation of the individual.

The MHTHU will have a dedicated multi-disciplinary team comprising of a psychiatrist, a mental health clinician (MHC), a mental health specialist (MHS) with alcohol and drug certification, a psychiatric technician, and a nurse. The clinical milieu will incorporate individual Cognitive Behavioral Therapy, Moral Reconciliation Therapy (MRT), Motivational Interviewing, and Seeking Safety. These are evidenced based programs with studies supporting reduced recidivism by nearly two-thirds over periods of six months to over two years. Inmates who are diagnosed with co-occurring substance abuse disorders, as well as a serious mental illness and the need to implement cognitive behavioral substance abuse programming, will be housed in the MHTHU to receive this focused treatment. Weekly clinical case reviews of inmates housed in the MHTHU will evaluate progress, treatment needs and, upon discharge, target specific case management goals that will be managed by the MHS. The MHC in conjunction with the psychiatrist, a psychiatric technician, and the MHS will be responsible for the clinical services offered in the MHTHU. The MHS will also work closely with inmates in the unit to develop a discharge/transition plan focusing on their specific needs. The discharge/transition plan

is a critical component in the transition to general population and/or identifying resources and support for continued success upon re-entry into the community. The MHS will follow the inmate 30 days after discharge/transition from the MHTHU to ensure continued treatment compliance with their individualized plan.

The chart below lists proposed new mental health treatment programs that will be implemented in the MHTHU:

<b>NEW MENTAL HEALTH TREATMENT PROGRAMS</b>	
<b>Type of Program</b>	<b>Description</b>
Moral Reconciliation Therapy (MRT)	A systematic treatment strategy that seeks to decrease recidivism among adult criminal offenders by increasing moral reasoning. It is a cognitive behavioral approach that combines elements from a variety of psychological traditions to progressively address ego, social, moral, and positive behavioral growth. MRT is evidenced based and one of the most widely implemented cognitive behavior programs. The studies found that MRT cut recidivism by nearly two-thirds over a time period of six months to over two years. Specifically designed for treatment resistant individuals.
Motivational Interviewing (MI)	Techniques to increase the likelihood of a patient considering, initiating and maintaining specific change strategies to reduce harmful behavior. MI is a subtle balance of directive and client-centered components shaped by a guiding philosophy and understanding of what triggers change. MI is an evidence-based practice that is goal directed, client centered counseling style for eliciting behavioral change by helping clients to explore and resolve ambivalence.
Mental Illness/Stress Management Group	Group that will assist the client with gaining understanding of mental health issues, making choices about treatment and preventing decompensation while incarcerated and upon release. Utilization of coping skills and stress reduction behaviors, relaxation techniques and stress prevention.
Mental Simulation/Rational Thinking Group	Group discussion and processing of choices, consequences/outcomes and goals in relation to various life situations. Goal is to increase attention and concentration ability, while fostering reality based thinking.
Recreational/Social Activity Group	Group with specific goal to improve social and interpersonal skills, while teaching healthy boundaries. Specifically addressing appropriated communication skills, increase motivation while also fostering sharing of opinion, thoughts and effective negotiation skills.
24/7 Mental Health Clinician Coverage	Coverage will be available in the new MHTHU and in Booking

**Pre-Release/Post-Release Continuum of Care:** The proposed new and expanded programs space will allow the SJSO to provide a broader range of evidence-based programs to a greater number of offenders. This will allow more offenders to be engaged in productive activities while incarcerated, benefiting offender management. It will also provide offenders with greater opportunities to address their underlying problems and needs – and return them to the community in better condition and equipped to be productive members of society with the goal of reducing recidivism.

**Continuum of Care Services Offered:** AB 109 MHS: The MHTHU will provide space for a specialized target specific AB 109 case manager, who will work specifically with the AB109 population. Early identification and engagement by the AB 109 case manager will result in more effective treatment planning/discharge planning. Further this individual will actively work with specialty mental health courts (AB109 and Compliance Court), as well with the Probation Daily Reporting Center, Parole, Behavioral Health, and community based organizations. The AB109 case manager will also follow the individual upon release for 30 days to ensure connection with support in the community.

Discharge Planning; Individuals released from jail and returning into the community are eligible for a discharge plan – whether they have been receiving mental health services or not. Discharge plans identify resources in the community such as shelter, community based and faith based organizations, and health agencies, among others. The discharge plan also allows continuity of care for those individuals who are receiving mental health services and/or alcohol and drug services and desire to continue with their treatment.

Warm hand-offs to agencies in the community and Behavioral Health Services (BHS); specifically planned releases of the inmates to a designated agency with an identified point person from the accepting agency is a key component to successful re-entry. Warm hand-offs also include the MHS arranging for transportation, offering additional support, and meeting the person at the agency for introductions and continued treatment planning.

Veteran's Outreach; A Veterans Administration justice outreach worker will meet bi-weekly with inmates who are veterans. A clinician is internally assigned to each veteran inmate and will work in conjunction with the VA to ensure services upon release from jail. This clinician is also associated with the county's Veteran's Treatment Court and all responsibilities associated with the court.

Assisting Re-entry for Co-Occurring Adults through Collective Support (ARCCS); The ARCCS partnership is led by Probation with the Sheriff, BHS, the Community Resources for Justice's Crime & Justice Institute and an array of public/private partners. ARCCS' purpose is to replicate the Transition Age Youth Grounds for Recovery re-entry program with the full jail population and embed it within other local, Community Corrections Partnership (CCP) managed correctional reform strategies that have decreased recidivism and reduced violent crime. ARCCS will provide 120 inmates with co-occurring disorders – and who are high risk and have high needs – with enhanced screening, assessment, treatment, and re-entry services. Post-release services will include assessment-based case planning and comprehensive recovery supports. ARCCS' project goals are to: 1) demonstrate better outcomes for high risk adult offenders,

including reduced recidivism rate; 2) strengthen and sustain re-entry services; and 3) develop a toolkit as a roadmap for others to implement effective re-entry services.

PHF or CSU (Crisis Stabilization Unit); This unit provides coordination and transport for those individuals who are incarcerated and/or released who are unable to re-enter into the community safely. This includes a mental health evaluation which identifies whether the person meets the 5150 criteria or if the individual is voluntarily requesting mental health services.

Financial Support will come from AB109 funding, the County Office of Education (which funds jail teaching staff), and the Inmate Welfare Fund. Other sources of aid will be provided by volunteers in the community, local community colleges, and other county and government agencies that provide services to the County's offender population (Behavioral Health Services, Child Support, WorkNet, Probation, Human Services Agency, Public Health, District Attorney, etc.).

County Office of Education employees are certified to teach the following classes: Pre-Release/Ownership, GED/High School Diploma, Succeeding in Life and Career, Math, Creative Writing, and Office Technology. We will continue to contract with Friends Outside, whose staff are trained to provide evidence-based programming including: anger management, parenting, substance abuse, and creative conflict resolution. The SJSO will work in collaboration with Probation to ensure that all evidenced-based programs work concurrently and in conjunction with post-release programs.

The replacement bed construction will incorporate expanded, adjacent programming space giving those who are incarcerated direct access to intensive evidenced-based programs and services which they can continue to access post-release.

This aligns fully with the CCP, which emphasizes evidenced-based programs and is supported by the Probation Department, County Behavioral Health, and a number of community based agencies, including Friends Outside.

Through intensive case management, the SJSO will connect programs and services with inmates to prepare them for release. Pre-release services will be tailored toward equipping offenders with the necessary tools to return to the community and begin a productive life post incarceration. Offenders completing all or most of the available programs will have the tools necessary to successfully gain employment, as well as linkages to organizations that can provide post-release support and resources. The services described above, principally offered by the Probation Department and Friends Outside, will be initiated within the jail in the new program space and continue following release.

The SJSO collaborates with many County and community-based agencies to offer a wide range of effective programs. These will be substantially expanded in the new and added program space. The chart below lists agencies which the County currently partners with, as well as a description of their services.

<b>AGENCY PARTNERSHIPS</b>	
<b>Agency</b>	<b>Description</b>
The Human Services Agency (HAS)	HSA assists the clients who are eligible for Cal Fresh, medical assistance, general assistance and cash aid. HAS requires an information packet to be completed prior to making an appointment with the Eligibility Worker at the Assessment Center. After the client has completed the packet, they are provided a copy of what they filled out.
Behavior Health Services (BHS)	BHS assists with a client's mental health issues and substance abuse issues. BHS staff will immediately meet with the client and schedule an appointment to have a mental health evaluation/assessment done as soon as possible. The assessment usually takes 2-3 hours.

WorkNet	WorkNet assists clients with obtaining employment. They provide workshops designed to prepare them for employment. WorkNet requests that the clients be “job ready”, meaning that they have valid identification.
Transitional Housing	Transitional Housing helps assist our clients who are homeless gain a place to stay. A Social Worker meets the client and provides them with a list of housing that they contract with. The client is then responsible for contacting the different housing locations on the approved list to see if there are vacancies.
Assessment Center Receptionist	When making a referral to an agency housed at the Assessment Center, the Probation Officer must provide a copy of the referral to the Assessment Center Receptionist and one to the client

**Proposed Vocational Programs:** In conjunction with the new Mental Health Treatment Programs, the SJSO also plans to implement the proposed vocational programs (below) in the SB 1022 and SB 844 projects. Securing employment has been shown to facilitate successful re-entry for individuals leaving correctional facilities. The objective is to establish and provide career training programs for inmates. These programs will offer “real life” job training during their incarceration to better prepare them for post-release.

**Pre-Apprenticeship Carpenter Program:** The program is a 9-week construction “boot camp”. Inmates will develop skills needed to succeed as a working carpenter. The program employs a hands-on project based learning methodology while teaching skill building, safety, cutting edge construction techniques, and physical conditioning. Participants have the opportunity to become involved with the local Carpenter’s Union, which offers program participants technical advice, guest speakers, and general assistance upon release.

**Warehouse Program:** The warehouse program is run through the County Office of Education and is 12 week long course. This program has a 100% job placement record



and the majority of the participants are parolees with successful job placement regardless of their criminal history.

**Construction Program:** The County Office of Education offers a 12 week construction training program. Participants learn basic flooring installation and safety. The program has nearly a 100% job placement.

**Truck Driving Program:** This program is to prepare inmates for a successful career as Class A commercial Truck Drivers in either a local or over-the-road setting. The program includes classroom training and behind-the-wheel instruction. Training will include the DMV competencies required for a Class A commercial license and endorsements, as well as job placement assistance. The program is 8 weeks long and successful graduates will receive a certificate of completion.

**Culinary Program:** The County Office of Education provides a culinary program that prepares students for entry-level positions in the food service and catering industry. Instruction includes sanitation and safety, customer service, menu and formulas, types of food services, food preparation, and pre-employment training. The culinary program is a 12 week long program and participants receive a certificate of completion.

**Business Technology:** Inmates will have the opportunity to enroll in a series of computer classes leading to certificates of completion, verifying competencies, or single computer courses designed for entry-level employment and expanding general office skills. These programs are 12 weeks long and participants receive a certificate upon completion.

**Mini-Academy in Agriculture, Logistics, Health Science, and Computer Science:** The County Office of Education will provide a mini-academy for the programs

they currently offer including agriculture, logistics, health science, computer science, etc. Inmates will participate in a two week course with objective to educate them in the vocational programs are available upon release.

**DUI Programs:** DUI programs are licensed by the State of California to provide education and counseling services to individuals who have been arrested for driving after consuming alcohol or other drugs. The goal of these programs is to reduce recidivism, promote abstinence, and introduce and encourage a sober. DUI programs include intake, assessment and referrals, education sessions, group counseling sessions, individual counseling sessions (when group counseling is not appropriate), and individual case monitoring sessions. All sessions are conducted by counselors who meet the certification requirements set by the State and by the counselor's certifying agency.

**Substance Abuse Educational Sessions:** Educational sessions are two hours in length and are informational in content and instructional in manner of presentation. Sessions may consist of lectures, seminars, films, audio tapes, written exercises, or any combination thereof.

**Group Counseling Sessions:** Group counseling sessions are two hours in length. (The DUI program may substitute one hour of individual counseling sessions for every two hours of group counseling sessions if participant is unable to participate in or benefit from group sessions due to a language barrier, emotional problem, or other difficulty).

**Face-to-Face Interviews:** The DUI program conducts face-to-face interviews on a regularly scheduled basis with minimum interviews of 15 minutes. Interviews go longer when the interviewer or the participant determines that additional time is needed.

### **Staffing for Programming, Services, and Housing**

**Programming:** Community service providers, Friends Outside, the Probation Department, and contracted service providers will continue to support and supplement programming needs at the new facility. These agencies will provide needed resources for the current and expanded programs. With the additional program space provided in the new facility, there will be an increase in programs. Funding for these programs will be provided through existing revenues sources such as San Joaquin County CCP.

**Medical and Mental Health Services:** The SJSO will continue to contract with CHS to provide medical, pharmacy, and mental health services. San Joaquin County Board of Supervisors supports SB 1022 and SB 844 projects by agreeing to increase medical and mental health staff. Medical will add seven full time employees for the SB 1022 base project. Mental Health will add nine full time employees for the SB 844 MHTHU.

**Housing and Support:** The new facility is specifically designed to be staff efficient and minimize movement for services. The current security and support staff will remain in the new facility; an increase in staff is not anticipated for the facility that will replace the Honor Farm. Further, the new medium security facility will function with the same staffing pattern to provide the supervision required to maintain span of control.

**Risk-assessment-based Pretrial Release Program:** The SJSO, in collaboration with the Probation Department and the National Institute of Corrections, has implemented a validated pretrial risk assessment tool, which assists with jail population management. However, the jail is also managing its population under the auspices of a Superior Court Consent Decree (court cap), and has been since 1989. The court cap is not an objective

tool and does not manage the jail's population in an effective manner. It is strictly offense based and does not consider the offender's risk to re-offend. The Probation Department is responsible for the Pre-Trial Services Unit located in the jail booking area that screens offenders for potential release. Utilization of the validated risk/needs assessment procedure has made a major contribution to the jail's population management because it considers the offender's risk to re-offend.

The SJSO is committed to using an evidenced-based pretrial assessment tool and, together with Probation, utilizes the *Virginia Pretrial Risk Assessment Instrument* (VPRAI) to assist and identify the risk of failure to appear in court if an offender is released pending trial. The SJSO and Probation Departments are already collaborating to provide a continuum of care from the time the offender enters and exits the facility.

The Probation Department has been using pretrial risk assessment instrument since November 2014. Pretrial Services will implement the VPRAI on all felony bookings and new misdemeanor bookings for charges of elder abuse, domestic violence, child abuse, sex offenses, and DUI with a prior in the past 10 years. The VPRAI will also be conducted on all bench warrants for the above noted charges, as well as any other misdemeanor charge that has had five or more failures to appear for the current charge as noted on the Bench Warrant Abstract.

All misdemeanor charges that do not qualify to have the VPRAI will be released on their Own Recognizance (O.R.) pursuant to the Court Consent Decree. For those assessed using the VPRAI, detain/release decisions will be based on their risk score, which identifies the defendants likelihood to appear in court and their risk to reoffend while going through court proceedings. Those inmates scoring "0" through "2" will be released

on their O.R. and will receive varying degrees of monitoring which include either phoning Probation, court reminder phone calls, reporting to Probation in person, or all of these measures. Those inmates that score “3” will remain detained pending arraignment with the completion of a Pretrial Report. These defendants will be recommended for release on GPS monitoring. Inmates scoring a “4 or above” are detained and recommended to remain detained pending their court proceedings.

**Percentage of inmates on Pre-Trial Status between  
January 1, 2015 through December 31, 2015**

	Unsented Males	Unsented Females	Sented Male	Sented Female	Total ADP
January 2015	681	60	395	47	1183
February 2015	732	79	407	50	1268
March 2015	710	69	395	47	1221
April 2015	704	86	399	51	1240
May 2015	668	74	382	52	1176
June 2015	704	83	388	58	1233
July 2015	667	68	431	71	1237
August 2015	691	88	391	65	1235
September 2015	669	97	420	66	1252
October 2015	663	79	402	76	1220
November 2015	758	93	376	68	1295
December 2015	718	80	385	65	1248
<b>Total</b>	<b>697</b>	<b>80</b>	<b>398</b>	<b>60</b>	<b>1234</b>
	777 unsented inmates average for 2015				
	458 sented inmates average for 2015				
	1234 average ADP for 2015				
	63% unsented average for 2015				
	37% sented average for 2015				
Source: San Joaquin County Sheriff's Office					

In Planning for Public Safety Realignment and the CCP, the SJSO has embraced the goal of maximizing the use of existing bed space and reducing the offender

population. A comprehensive approach will be taken by the SJSO to minimize the population in detention, and return as many offenders as possible to the community, consistent with public safety.

#### 4: ADMINISTRATIVE WORK PLAN

**Describe the steps required to accomplish this project. Include a project schedule, and list the division/offices including personnel that will be responsible for each phase of the project, and how it will be coordinated among responsible officials both internally and externally.**

San Joaquin County has developed a project management, construction, and administrative work plan specifically to address the needs of the proposed SB 844 Mental Health housing project concurrent with its SB1022 partially funded detention facility project. This work plan leverages County resources while assuring that the project scope, schedule, construction budget, and construction quality are maintained. The work plan methodology described below is consistent with other capital improvement projects undertaken by San Joaquin County. The County has selected the Design-Bid-Build Delivery Method for this project to provide the best project for the dollar and minimize potential risks.

**Project Management:** The project will be planned, managed and overseen – from start to finish – by a Project Management Team (PMT), the Architect/Engineer (A/E), and supported by a Construction Management (CM) consultant. Members of the PMT and the A/E have been involved in the SB1022 reversionary funding project planning as well as

the preparation of this application and will continue to participate throughout the following project phases: planning, programming, schematic design, design development, working drawings, bidding, construction, move-in, and post-occupancy.

The PMT will be comprised of representatives from the SJSO, Capital Projects, County Administrator's Office, Correctional Health, as well as representatives from other County agencies *as needed*:

### **Project Management Team**

- Kimberly Moule – Captain, Sheriff's Custody Division
- Michael Tibon – Lieutenant, Sheriff's Operations and Transition Team Planning
- David Castagna - Capital Projects Administrator
- Marcia Cunningham – Director, County General Services Department
- Deb West – Assistant County Administrator
- Stacey Hernandez – Deputy Director of Correctional Healthcare
- Kris Hamilton - Sheriff's Inmate Programs Director
- Cyndee Borges – Mental Health Treatment Coordinator
- Brian Beckman – District Maintenance and Construction Superintendent

The PMT will provide regular updates to the Board of Supervisors. Additionally, Marcia Cunningham has been designated as the County Construction Administrator. The San Joaquin County General Services Department-Capital Projects Administration will provide overall coordination of the project and provide direct administration and oversight of the PMT. They will also oversee and manage the A/E team and CM.

SJSO members include Michael Tibon, Steve Kowalczyk, Noble Mead, and Erika Plante as the Transition Team and Cyndee Borges, Mental Health Treatment and

Program Coordinator. These individuals will represent the interests of the Sheriff and provide technical assistance and operational expertise.

Sandra Regalo will serve as the County Financial Officer and coordinate with other County Departments on all financial aspects of the project, including close coordination with the County Treasurer and Tax-Collector for cash management.

As noted above, a CM will be contracted to provide project and documentation support of construction management procedures throughout the project. Lionakis, a recognized architecture firm with extensive correctional experience, will be responsible for the development of the construction documents, bidding support, and construction administration support.

Capital Projects Administration will process consultant and contractor payment applications, and in turn, submit them to the State for reimbursement. Designated County staff will respond to the Board of State and Community Corrections (BSCC) on all contract matters, and the A/E will respond to all minimum code and standards issues. An integrated project delivery process, led by the County and the CM, will be used for programmatic and quality control, monitoring, scheduling, and coordinating all activities on behalf of the County and the SJSO.

**Project Events and Timeline:** The development of the project events and timeline has been completed in collaboration with the PMT and the A/E to ensure that the dates are achievable. This timeline includes the requirements and review periods of State agencies, including the BSCC, the State Public Works Board, the Department of Finance, and the Office of the State Fire Marshal. Major project events and timeline are listed on the schedule below:



ID	Task Name	Start	Finish	2017					2018					2019					2020										
				6	7	8	9	#	#	1	2	3	4	5	6	7	8	9	#	#	1	2	3	4	5	6	7	8	9
1	Notice of Award	6/14/2017	6/14/2017	■																									
2	Site Assurance	6/14/2017	9/13/2017	■	■	■	■																						
3	Real Estate Due Diligence	6/14/2017	10/13/2017	■	■	■	■	■																					
4	Project Establishment	6/14/2017	11/9/2017	■	■	■	■	■	■																				
5	Schematic Design	6/14/2017	11/16/2017	■	■	■	■	■	■																				
6	Design Development	11/17/2017	3/13/2018							■	■	■																	
7	BSCC/SFM Page Turn	2/27/2018	2/27/2018								■																		
8	SPWB	6/14/2018	6/14/2018								■	■	■	■															
9	Construction Documents	3/14/2018	9/14/2018								■	■	■	■	■														
10	BSCC/SFM Review	9/3/2018	12/17/2018													■	■	■											
11	DOF Proceed to Bid	12/18/2018	1/14/2019																	■									
12	Bidding and Award	1/17/2019	5/17/2019																	■	■	■	■						
13	Notice to Proceed	5/20/2019	5/20/2019																			■							
14	Construction	5/21/2019	8/10/2020																			■	■	■	■	■	■	■	■
15	Occupancy	8/11/2020	10/5/2020																							■	■	■	

A comprehensive work plan has been developed for the SB 844 MHTHU project in concert with the current SB 1022 partial award. This work plan includes proven project delivery methods to ensure successful completion of the proposed scope on time and within budget. The plan also includes BSCC and State mandated requirements for funding. The plan consists of the following elements:

- Completion and submittal of Site Assurance and Real Estate Due Diligence
- Development of the staffing plan and operation program statement
- Monitoring and refinement of the Project Schedule
- Preparation of schematic design and design development documents.
- Transition planning that has already begun with the establishment of the transition team during concept designs of the SB1022 partial award project and continues through move-in and post-occupancy activities.
- Design/value engineering and life-cycle costing to ensure efficient use of materials resources (i.e. the provision of a cost effective design).
- Continuous user input from the SJSO staff, Correctional Health, and others who will provide programs and services at the new facility.

- Independent cost estimates during the design and construction document phases.
- Continuous analysis of the requirements of Titles 15, 19, and 24 of the California Code of Regulations including required reviews and inspections by BSCC and the State Fire Marshal.
- Ongoing schedule review and analysis to ensure that the project will be ready for occupancy as planned.
- Preparation of construction documents (drawings and specifications) including the required reviews by BSCC and the State Fire Marshal.
- Constructability reviews during design *and* during the preparation of construction documents to ensure the use of effective construction means and methods, as well as to ensure competitive bidding and reduce change orders.
- Construction administration, and coordination and inspection.

Construction closeout activities include: punch list development and monitoring completion of punch list work; cost reconciliation and final audit; final invoice and progress payment; collection of warranties; and collection of operation and maintenance manuals. Transition and move-in activities include: equipment and furnishing commissioning; facility “shake-down”; operations and security “walk-through”; and staff training.

## 5: BUDGET

**Describe the amounts and types of funding proposed and why each element is required to carry out the proposed project. Describe how the county will meet its funding contribution (match) requirements for all project costs in excess if the amount of state financing requested and how operational costs (including programming costs) for the facility will be sustained.**

Lionakis was contracted with San Joaquin County to provide the Needs Assessment validation, programming, and the conceptual design for the new dormitory housing units, inmate and staff support areas, and multiple program spaces for the partially funded SB1022 replacement project and the SB 844 MHTHU and support spaces of this SB844 application. The design was based on square footages derived from (1) SJSO staff discussions regarding space needs, (2) acceptable functional use areas and spaces utilized in similar facilities, (3) current and anticipated future programs, and (4) state minimum jail standards. A professional cost-estimate was provided by Cumming and included discussions on current staffing patterns compared to the conceptual design, appropriate contingency, and construction costs escalated to the projected mid-point of construction. The construction estimate was reviewed by the County and Lionakis for accuracy and intent. Fees, equipment and systems, site development, and staffing for the project budget were based upon the scope of the conceptual design and the complexity of the project type. Percentages and allowances were determined by industry standards, market information, and experience from prior construction projects.

The proposed project has been planned with simple but clean housing unit delineations between classifications, efficient direct supervision staff positions, and clear lines of sight to security detention areas and other more open building program spaces. Throughout the design process, the County will seek to realize efficient capital costs by identifying, proposing, and utilizing cost effective methods of construction and economies of scale while balancing long term operational costs.

For the SB844 MHTHU and SB1022 replacement facility, the SJSO and County Administrator's Office staff are committed to a staff efficient building design that will

translate into reduced long-term lifecycle costs. Proposed program, medical, receiving, and inmate services spaces will incorporate aspects and components which research and currently implemented programs have proven will aid in reducing recidivism. The new facilities will specifically provide much needed program and vocational training opportunities for qualified inmates. This will directly contribute to offender re-entry efforts. This will also provide the County with the ability to implement more varied inmate mental health treatment and programming options in a more secure and safe, durable but normative, and energy efficient building.

**Programming:** Contracted service providers, community providers including Social Services Department, Probation Department, and Friends Outside will continue to support programming needs at the new facility. These agencies will provide the needed resources for the expanded and additional services that will be offered in the additional program space at the new facility. Funding for these services and programs will be provided through existing revenue sources such as the San Joaquin County CCP AB109 funding, the County Office of Education which funds jail teaching staff, and the Inmate Welfare Fund.

**Mental Health Treatment and Medical Services:** These services will continue to be provided through county Correctional Health staff. An increase in Correctional Health staffing will be required and further presented below.

**Housing and Correctional Staff:** The SJSO and the PMT worked collaboratively to develop the conceptual design process for the new SB1022 and SB844 facility, including tours of other facilities, to create options that optimize staff operational efficiency *but are also* safe to operate. The team reviewed staffing levels at the existing Honor Farm

and compared them to the design proposed for the new facility. Given the arrangement of the housing units and support service areas for the new facility, staffing needs will be similar to the Honor Farm and *will not* require additional correctional positions. This includes positions such as Sergeants, Correctional Officers, Clerical Staff, Custody Supervisors, etc. The combined gross square footage of both SB 1022 and SB 844 projects is only 5% larger than the existing Honor Farm. While the new facility is marginally larger it will be much more energy efficient and costs for utilities (electricity, gas, sewer and water) will be less. The number of plumbing fixtures in the new SB1022 facility will be similar to existing Honor Farm with an increase in fixtures for the SB844 (due to the MTHU and single cells). However, fixtures in the new facility will be highly efficient and metered. As a result, the project will not incur additional operational costs for water and sewer services. Additionally, with fewer beds compared to existing facility, operational costs for food, medical, and other daily operational supplies are expected to be the same (or slightly reduced) for the new facility. An increase for Correctional Health staff to support the MTHU is warranted. The increased operational costs were recently presented to the Board of Supervisors for review and concurrence. Below please find staffing requirements for Custody and Correctional Health:

Custody and Program Staffing (No Increased costs)

Current Honor Farm and New SB1022 and SB844 Staffing			
Day Shift	10 - Correctional 1 – Visiting Officer	1 - Sergeant 3 - Recreation	3 to 4 - K9 Officers 6 – Program (M – F)
Evening Shift	9 –Correctional	1 - Sergeant	

Correctional Health Staffing and Facility Maintenance

Proposed Staffing Increase			
SB 844	8.7 – Healthcare FTE's	Facility (0.4 FTE, SF cost)	\$882,000 annual
SB1022	7.5 – Healthcare FTE's	Facility (1.6 FTE, SF cost)	\$980,000 annual

Source: San Joaquin County Sheriff's Office

**County Match and Additional Costs:** The PMT has thoroughly reviewed all of the associated project costs and filled out anticipated 3-page estimates for SB 844, SB 1022, and a combined 3-page estimate for both projects. The SB 844 project is an extension of the base SB 1022 and several *economies of scale* shall be realized. Project costs such as inspectors, special inspections, utilities, administration, etc. will be concurrent activities and allocated towards the base project. Therefore the SB 844 project will be not seeking state reimbursement for several of these potential additional eligible costs. The county is committed to completing the project in the most efficient manner and the ability to control design schedule is critical to minimize escalation. Both projects will be designed and reviewed concurrently with architectural fees funded with cash match.

**6: READINESS TO PROCEED**

**Did the county provide a board resolution and CEQA documentation?**

San Joaquin County has provided as part of the SB 844 submittal a Board Resolution and CEQA documentation evidencing readiness to proceed.

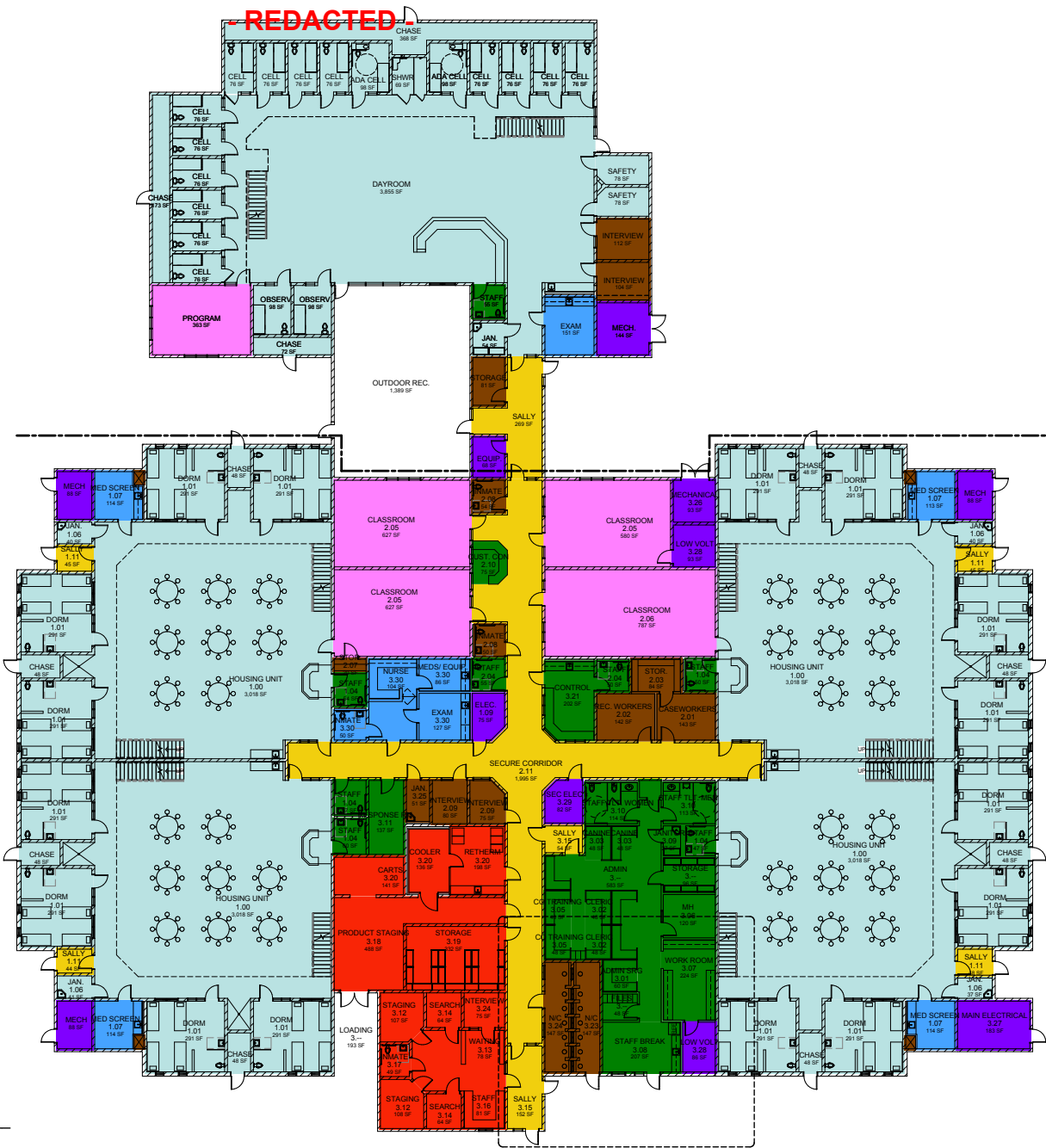

SB844  
↑  
↓  
SB1022

**SB1022**  
MAIN FLOOR LEVEL  
UPPER TIER  
32,528 SQ. FT.  
9,108 SQ. FT.

**SB844**  
OUTDOOR REC.  
HOUSING LEVEL 1  
HOUSING UPPER TIER  
1,402 SQ. FT.  
8,340 SQ. FT.  
2,412 SQ. FT.

TOTAL 53,790 SQ. FT.

- PROGRAM
- STAFF & ADMIN
  - CIRCULATION
  - MEDICAL
  - MECHANICAL/ELECTRICAL
  - PROGRAMS
  - RECEIVING + TRANSPORTATION
  - SUPPORT
  - HOUSING - LEVEL 1



# COMBINED SB1022 AND SB844 FLOOR PLAN

- REDACTED -

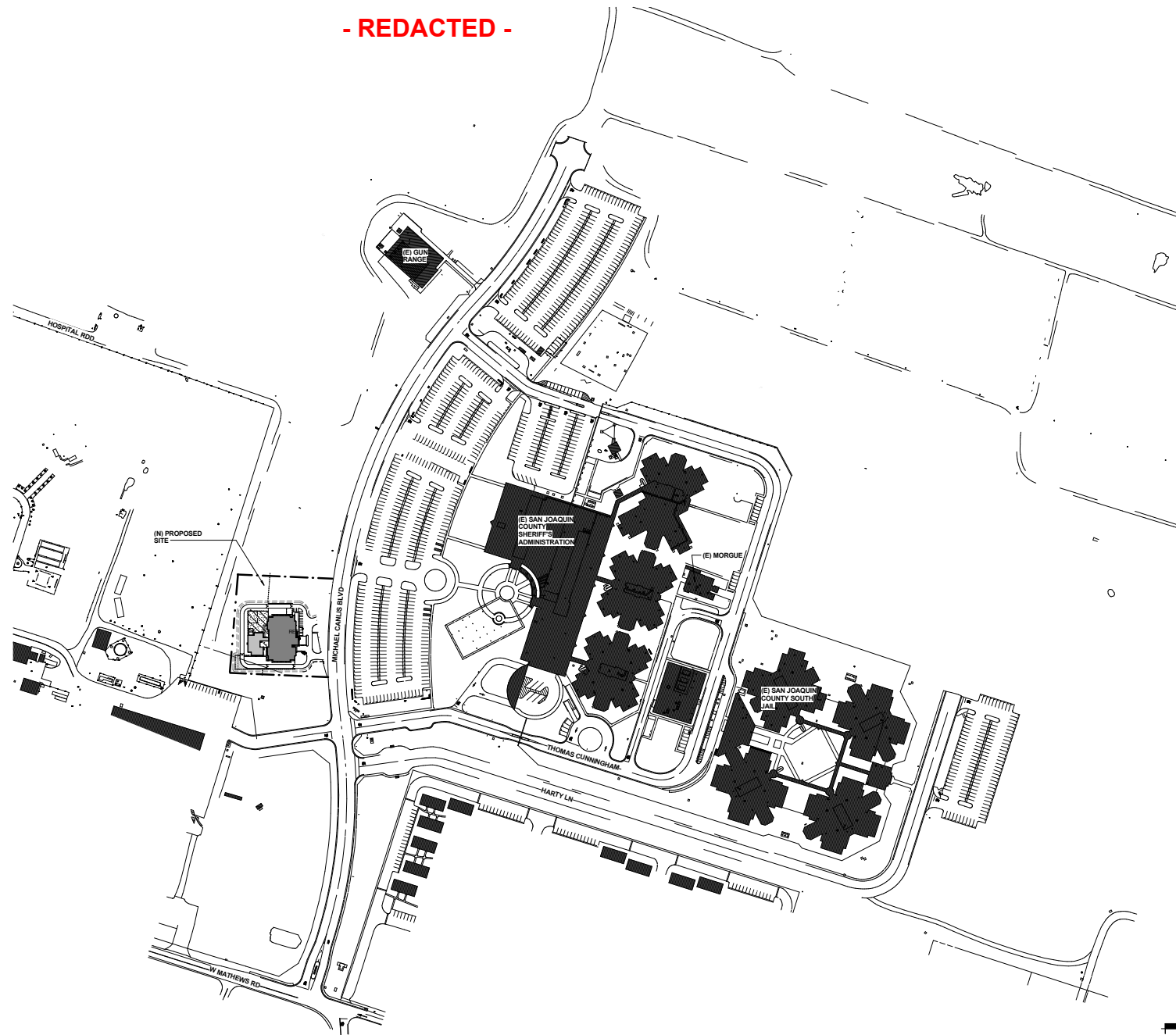

EXISTING  
HONOR FARM

# OVERALL SITE PLAN

SAN JOAQUIN COUNTY FEBRUARY 2017



- REDACTED -

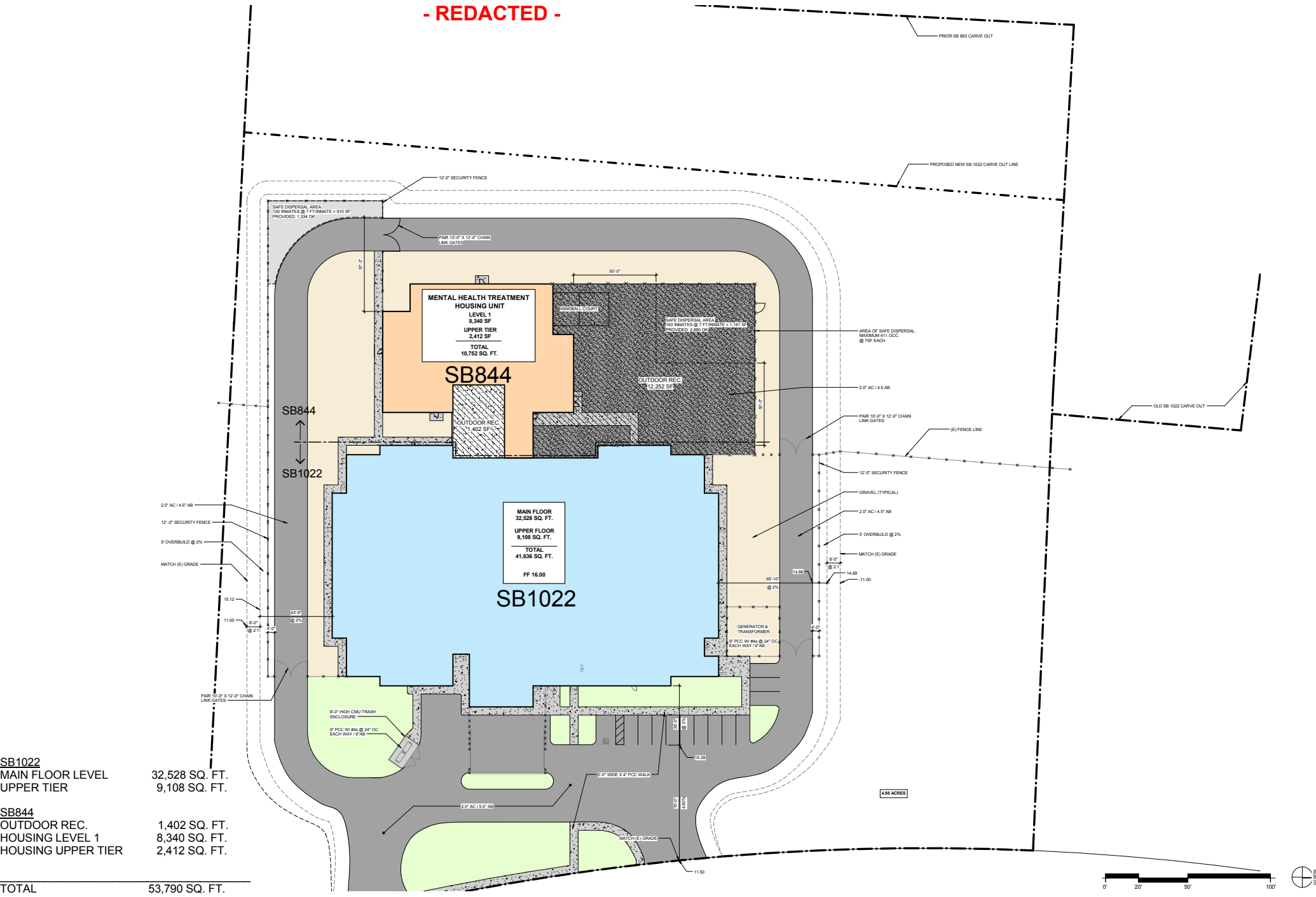

# COMBINED SB1022 AND SB844 SITE PLAN

BEFORE THE BOARD OF SUPERVISORS OF THE COUNTY OF SAN JOAQUIN  
STATE OF CALIFORNIA

R E S O L U T I O N

R-17-14

APPROVE THE APPLICATION FOR THE SB 844 ADULT CRIMINAL FACILITIES  
CONSTRUCTION PROGRAM

-----

WHEREAS, on June 27, 2016, Senate Bill 844 (SB 844) became State law and authorized \$270 million in lease-revenue bond financing to construct adult local criminal justice facilities;

WHEREAS, the Board of State and Community Corrections is responsible for administering SB 844 funding via competitive award;

WHEREAS, San Joaquin County intends to submit a proposal to the BSCC for a Special Needs Housing Unit (Additional Alternate) Project and request SB 844 funding in the amount of \$7,672,000; and,

WHEREAS, the County of San Joaquin is seeking funding preference for its proposed project within the Adult Local Criminal Justice Facilities Construction Financing Program (the "SB 844 Financing Program").

NOW, THEREFORE, BE IT RESOLVED that the Board of Supervisors of San Joaquin County does hereby represent, warrant and covenant as follows:

- A. The County designates the following individuals to act in the specified capacities:  
County Construction Administrator: Marcia Cunningham, Director of General Services  
Project Financial Officer: Sandra Regalo, Senior Deputy County Administrator  
Project Contact Person: Kimberly Moule, Correctional Captain  
Project Contact Person: Michael Tibon, Correctional Lieutenant.
- B. Approving the forms of the project documents deemed necessary, as identified by the board (SPWB) to the BSCC, to effectuate the financing authorized by the legislation. The forms may be executed by the Chair of the San Joaquin County Board of Supervisors or the County Administrator.
- C. Authorization and designation of the following official to sign the Agreement and submit the proposal for funding: Charles Winn, Chair, San Joaquin County Board of Supervisors
- D. Assurance that the County will adhere to state requirements and terms of the agreements between the County, the BSCC, and the SPWB in the expenditure of state financing and County match funds.

- E. Assurance that authorizes an adequate amount of available matching funds to satisfy the County's contribution. The identified matching funds shall be compatible with the states' lease revenue bond financing.
- F. Assurance that the County will fully and safely staff and operate the facility that is being constructed (consistent with Title 15, California Code of Regulations, Chapter 1, Subchapter 6 section 1756(j)5) within ninety (90) days after project completion.
- G. The County shall provide the following site assurance for the County facility at the time of proposal or not later than 90 days following BSCC's notice of Intent to Award: 1) assurance that the County has project site control through either fee simple ownership of the site or comparable long-term possession of the site and right of access to the project sufficient to assure undisturbed use and possession of the site; and, 2) will not dispose of, modify the use of, or change the terms of the real property title, or other interest in the site of facility subject to construction, or lease the facility for operation to other entities, without permission and instructions from the BSCC, for so long as the SPWB lease-revenue bonds secured by the financed project remain outstanding.
- H. Attestation to \$1,080,000 as the current fair market land value for the proposed new or expanded facility.

BE IT FURTHER RESOLVED the County has provided documentation evidencing CEQA compliance has been completed; documentation of CEQA compliance is a final Notice of Exemption; and a letter has been provided from County Counsel certifying the associated statute of limitations has expired and either no challenges were filed or identifying any challenges filed and explaining how they have been resolved in a manner that allows the project to proceed as proposed.

PASSED AND ADOPTED 02/07/2017, by the following vote of the Board of Supervisors, to wit:

AYES: **Villapudua, Miller, Patti, Elliott, Winn**

NOES: **None**

ABSENT: **None**

ABSTAIN: **None**

**Charles Winn**

ATTEST: MIMI DUZENSKI  
Clerk of the Board of Supervisors  
Of the County of San Joaquin,  
State of California



CHARLES WINN  
Chair, Board of Supervisors  
County of San Joaquin  
State of California

By **Mimi Duzenski**

- REDACTED -



OFFICE OF THE  
**COUNTY COUNSEL**

COUNTY OF SAN JOAQUIN  
44 NORTH SAN JOAQUIN STREET, SUITE 679  
STOCKTON, CA 95202-2931  
TELEPHONE: (209) 468-2980  
FAX: (209) 468-0315

**DEPUTY COUNTY COUNSEL:**  
LAWRENCE P. MEYERS  
MATTHEW P. DACEY  
KIMBERLY D. JOHNSON  
JASON R. MORRISH  
QUENDRITH L. MACEDO  
ROBERT E. O'ROURKE  
LISA S. RIBEIRO  
ANDREW N. ESHOO  
ZAYANTE (ZOEY) P. MERRILL

**J. MARK MYLES**  
COUNTY COUNSEL  
**RICHARD M. FLORES**  
ASSISTANT COUNTY COUNSEL  
**KRISTEN M. HEGGE**  
CHIEF DEPUTY COUNTY COUNSEL

**CHILD PROTECTIVE  
SERVICES COUNSEL:**  
(209) 468-1330  
DANIELLE DUNHAM-RAMIREZ  
SHANN S. KENNEDY  
ALISTAIR SHEAFFER  
ANGELIKA SINGH

February 21, 2017

Board of Supervisors  
County of San Joaquin  
44 North San Joaquin Street, Suite 627  
Stockton, California 95202

RE: Final Notice of Exemption

Honorable Board of Supervisors:

Funding preference under Senate Bill 1022 and Senate Bill 844 is given to counties that are most prepared to succeed. SB 1022 and SB 844 require the Board of State and Community Corrections to determine the funding and scoring criteria, including California Environmental Quality Act compliance, and publish them in the RPP. Proposals are then to be scored in accordance with those criteria. Included in these requirements is documentation evidencing CEQA compliance.

Therefore, in accordance with this requirement, this letter certifies that on January 13, 2017, a Final Notice of Exemption was filed with the CEQA Clearinghouse. Additionally, all related Statutes of Limitations have expired without challenge as of February 16, 2017.

Very truly yours,

A handwritten signature in blue ink, appearing to read "Matthew P. Dacey".

Matthew P. Dacey  
Deputy County Counsel  
County of San Joaquin

MPD/jms

1  
2  
3  
4  
5  
6  
7  
8  
9  
10  
11  
12  
13  
14  
15  
16  
17  
18  
19  
20  
21  
22  
23  
24  
25  
26  
27  
28

**CEQA Compliance Certification**

I, MATTHEW P. DACEY, hereby declare as follows:

1. I am an attorney at law duly licensed and admitted to practice before this Court and all courts of the State of California and am a deputy in the Office of the County Counsel for the County of San Joaquin.

2. I certify that on January 13, 2017, a final Notice of Exemption was filed with the CEQA State Clearinghouse.

3. I further certify that all related statutes of limitation have expired without challenge on February 16, 2017.

I declare under penalty of perjury under the laws of the State of California that the foregoing is true and correct and within my personal knowledge and, if called to testify, I could and would testify competently as to the matters set forth herein.

Executed on February 21, 2017, at Stockton, California.

  
\_\_\_\_\_  
MATTHEW P. DACEY

Notice of Exemption

Appendix E

To: Office of Planning and Research  
P.O. Box 3044, Room 113  
Sacramento, CA 95812-3044  
County Clerk  
County of: San Joaquin  
44 North San Joaquin Street, Suite  
260, Stockton, CA 95202

From: (Public Agency): San Joaquin County General  
Services Department, 44 North San Joaquin Street,  
Suite 590, Stockton, CA 95202  
(Address)

Project Title: San Joaquin County Detention and Program Facility

Project Applicant: San Joaquin County General Services Department

Project Location - Specific:  
North and Northeast of the existing Honor Farm Facility on the Honor Farm Complex site (999 West Mathews Road, French Camp, CA 95231)

Project Location - City: French Camp Project Location - County: San Joaquin County

Description of Nature, Purpose and Beneficiaries of Project:  
See Project Description. This is to advise that the San Joaquin County Board of Supervisors has approved the above-described project on October 8, 2013 (R-13-201); and the San Joaquin County General Services Department has made the determination that the project is exempt.

Name of Public Agency Approving Project: San Joaquin County General Services Department

Name of Person or Agency Carrying Out Project: San Joaquin County General Services Department

- Exempt Status: (check one):
- Ministerial (Sec. 21080(b)(1); 15268);
  - Declared Emergency (Sec. 21080(b)(3); 15269(a));
  - Emergency Project (Sec. 21080(b)(4); 15269(b)(c));
  - Categorical Exemption. State type and section number: Replacement or Reconstruction, § 15302
  - Statutory Exemptions. State code number: \_\_\_\_\_

Reasons why project is exempt:  
The project will have no significant impact on the environment or human welfare.

Lead Agency  
Contact Person: Marcia Cunningham Area Code/Telephone/Extension: (209) 468-3664  
mcunningham@sjgov.org (preferred)

- If filed by applicant:
1. Attach certified document of exemption finding.
  2. Has a Notice of Exemption been filed by the public agency approving the project?  Yes  No

Signature:  Date: 1/11/2017 Title: General Services Director

Signed by Lead Agency  Signed by Applicant

Authority cited: Sections 21083 and 21110, Public Resources Code. Date Received for filing at OPR: \_\_\_\_\_  
Reference: Sections 21108, 21152, and 21152.1, Public Resources Code.

Filed Doc #: **39-01122017-008**  
1/12/17 10:41 AM  
Steve J. Bestolarides  
San Joaquin County Clerk

## Project Description

### San Joaquin County Detention and Program Facility

#### Location:

San Joaquin County Honor Farm Complex site (999 West Mathews Road, French Camp, CA 95231).

#### Nature and Purpose:

The scope of the proposed San Joaquin County Detention and Program Facility is to replace the existing Honor Farm Facility housing which was originally constructed in 1949 and has far surpassed its useful life. The proposed project location is north and northeast of the existing Honor Farm Facility and adjacent to Michael N. Canlis Boulevard. The project area is approximately up to six acres and has historically been fallow land or cultivated for hay by a tenant farmer. Existing utility points of connection (water, wastewater, stormwater, electrical, gas, and telecommunications) are in close proximity.

Base Project – San Joaquin County has received a SB 1022 (State) partial conditional funding award which will allow for replacement of the existing Honor Farm Facility barracks with building up to four new medium security multi-tiered replacement housing units containing multiple occupancy dormitory style sleeping rooms and support space to operate the facility. Each housing unit will also include dayrooms, secure corridors, medical screening, interview and visiting areas, and Americans with Disabilities Act (ADA) accommodations. The housing units will have additional adjacent support spaces for a medical clinic and treatment, programs or classrooms, outdoor recreation, and receiving and transportation (control hub for inmate ingress and egress to various appointments and assignments). Activities that could occur in dedicated program spaces could include adult education, religious services and counseling, substance abuse classes, group counseling, mental health evaluations, and classes along with other programs to reduce recidivism.

Add Alternate – San Joaquin County intends to pursue additional State funding under SB 844. Based on this information, the County has developed an “Add Alternate” to the Base Project that would use the additional funding if and when awarded. The Add Alternate would be a new mental health and medical housing unit adjoining, contiguous, and included with the Base Project. A two tier housing unit has been developed as an extension from the secure corridor of the Base Project. This additional housing unit could provide the functions for a mental and medical health facility including safety cells, observation rooms, exam area, and dedicated program space.

At the conclusion of the project, all inmates will be moved from the existing Honor Farm Facility barracks and housed in the newly designed facility. The existing 124 Housing Unit could be utilized as a re-entry facility providing case management services to inmates who are within 90 days from release as they prepare for reintegration back into the community.

The California Board of State and Community Corrections (BSCC) Rated Capacity for the existing Honor Farm Facility is 470 beds. After the construction of the new San Joaquin County Detention and Program Facility, inmate housing capacity will be a BSCC Rated Capacity of up to 444 beds; up

to 320 beds in the San Joaquin County Detention and Program Facility and 124 beds in the existing 124 Housing Unit.

**Beneficiaries:**

The construction of the San Joaquin County Detention and Program Facility will significantly improve public, correctional officer, staff, and inmate safety. The project will fulfill a crucial need for a facility to serve inmates with dormitory style housing while providing treatment, academic, and vocational programs all within a secure perimeter with opportunity for outdoor recreation. The project will provide the correct type of housing beds to accommodate a variety of inmate classifications with a focus on treatment and rehabilitation. Reduction in recidivism is a desired outcome of the goal to properly prepare, educate, and train inmates prior to release. Public safety will be enhanced.



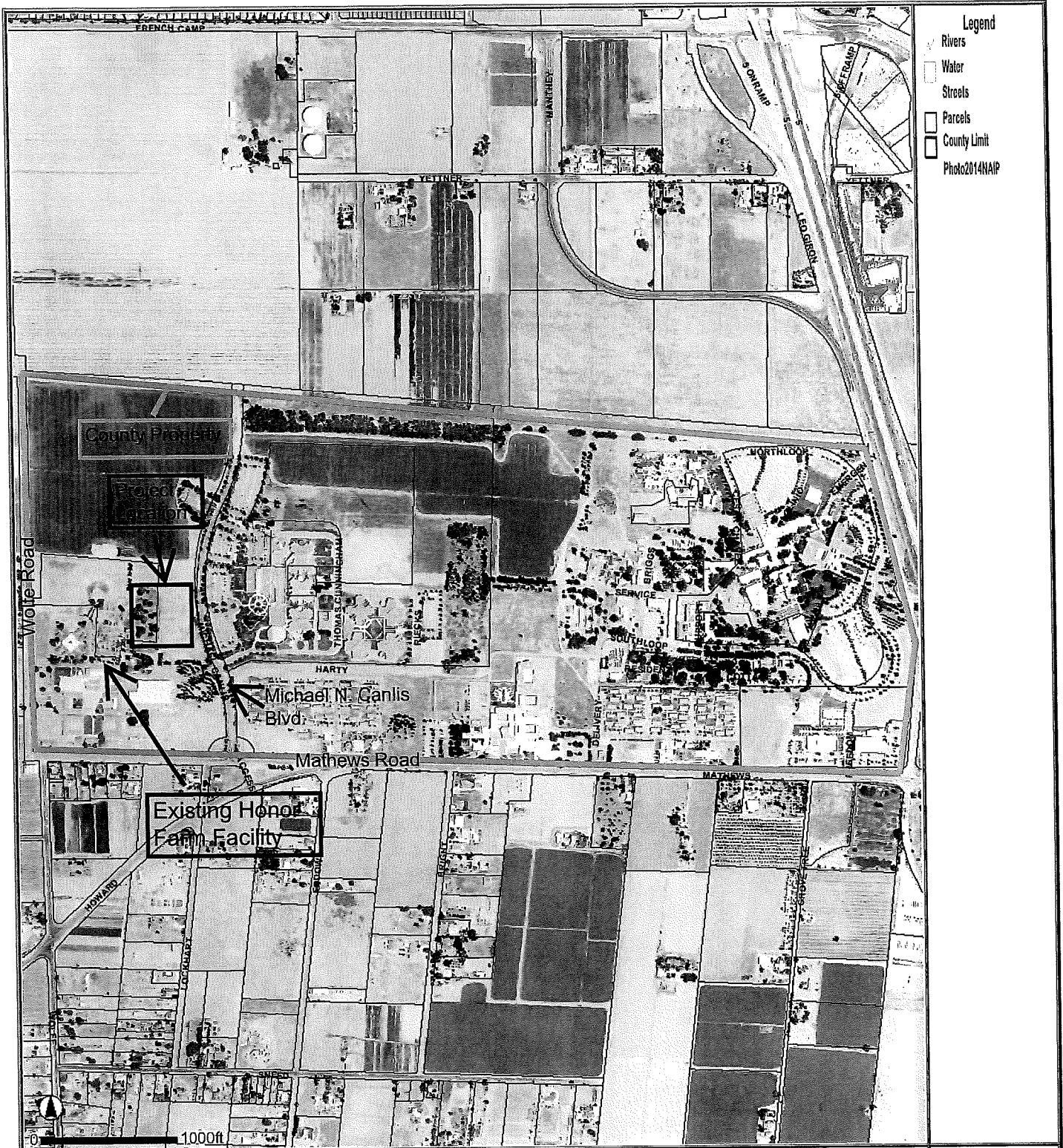

VICINITY MAP

San Joaquin County Detention and Program Facility  
7000 Michael N. Canlis Blvd., French Camp, CA





2017 ENVIRONMENTAL FILING FEE CASH RECEIPT

DFW 753.5a (Rev. 01/01/17) Previously DFG 753.5a

RECEIPT NUMBER: 39-01122017-008
STATE CLEARINGHOUSE NUMBER (If applicable)

SEE INSTRUCTIONS ON REVERSE. TYPE OR PRINT CLEARLY.

LEAD AGENCY SAN JOAQUIN COUNTY GENERAL SERVICES	LEAD AGENCY EMAIL	DATE 01/12/2017
--	-------------------	--------------------

COUNTY/STATE AGENCY OF FILING SAN JOAQUIN	DOCUMENT NUMBER 39-01122017-008
--	------------------------------------

PROJECT TITLE  
SAN JOAQUIN COUNTY DETENTION AND PROGRAM FACILITY

PROJECT APPLICANT NAME SAN JOAQUIN COUNTY GENERAL SERVICES	PROJECT APPLICANT EMAIL	PHONE NUMBER (209) 468-3664
---	-------------------------	--------------------------------

PROJECT APPLICANT ADDRESS 44 N SAN JOAQUIN ST STE 590	CITY STOCKTON	STATE CA	ZIP CODE 95202
--	------------------	-------------	-------------------

PROJECT APPLICANT (Check appropriate box)

Local Public Agency     School District     Other Special District     State Agency     Private Entity

CHECK APPLICABLE FEES:

- Environmental Impact Report (EIR) \$3,078.25 \$ \_\_\_\_\_
- Mitigated/Negative Declaration (MND)(ND) \$2,216.25 \$ \_\_\_\_\_
- Certified Regulatory Program document (CRP) \$1,046.50 \$ \_\_\_\_\_

- Exempt from fee
  - Notice of Exemption (attach)
  - CDFW No Effect Determination (attach)
- Fee previously paid (attach previously issued cash receipt copy)

- Water Right Application or Petition Fee (State Water Resources Control Board only) \$850.00 \$ \_\_\_\_\_
- County documentary handling fee \$ \_\_\_\_\_ \$50.00
- Other \$ \_\_\_\_\_

PAYMENT METHOD:

- Cash     Credit     Check     Other    TOTAL RECEIVED \$ \_\_\_\_\_ \$50.00

SIGNATURE X	AGENCY OF FILING PRINTED NAME AND TITLE Rosette Keopadubsy ,Deputy
----------------	---





2017 ENVIRONMENTAL FILING FEE CASH RECEIPT

DFW 753.5a (Rev. 01/01/17) Previously DFG 753.5a

RECEIPT NUMBER: 39-01122017-008
STATE CLEARINGHOUSE NUMBER (If applicable)

SEE INSTRUCTIONS ON REVERSE. TYPE OR PRINT CLEARLY.

LEAD AGENCY SAN JOAQUIN COUNTY GENERAL SERVICES	LEAD AGENCY EMAIL	DATE 01/12/2017
--	-------------------	--------------------

COUNTY/STATE AGENCY OF FILING SAN JOAQUIN	DOCUMENT NUMBER 39-01122017-008
--	------------------------------------

PROJECT TITLE  
SAN JOAQUIN COUNTY DETENTION AND PROGRAM FACILITY

PROJECT APPLICANT NAME SAN JOAQUIN COUNTY GENERAL SERVICES	PROJECT APPLICANT EMAIL	PHONE NUMBER (209) 468-3664
---	-------------------------	--------------------------------

PROJECT APPLICANT ADDRESS 44 N SAN JOAQUIN ST STE 590	CITY STOCKTON	STATE CA	ZIP CODE 95202
--	------------------	-------------	-------------------

PROJECT APPLICANT (Check appropriate box)

Local Public Agency     School District     Other Special District     State Agency     Private Entity

CHECK APPLICABLE FEES:

- Environmental Impact Report (EIR) \$3,078.25 \$ \_\_\_\_\_
- Mitigated/Negative Declaration (MND)(ND) \$2,216.25 \$ \_\_\_\_\_
- Certified Regulatory Program document (CRP) \$1,046.50 \$ \_\_\_\_\_

- Exempt from fee
  - Notice of Exemption (attach)
  - CDFW No Effect Determination (attach)
- Fee previously paid (attach previously issued cash receipt copy)

- Water Right Application or Petition Fee (State Water Resources Control Board only) \$850.00 \$ \_\_\_\_\_
- County documentary handling fee \$ \_\_\_\_\_ \$50.00
- Other \$ \_\_\_\_\_

PAYMENT METHOD:

- Cash     Credit     Check     Other    TOTAL RECEIVED \$ \_\_\_\_\_ \$50.00

SIGNATURE X	AGENCY OF FILING PRINTED NAME AND TITLE Rosette Keopadubsy ,Deputy
----------------	---





State of California - Department of Fish and Wildlife **REDACTED -**  
**2017 ENVIRONMENTAL FILING FEE CASH RECEIPT**  
 DFW 753.5a (Rev. 01/01/17) Previously DFG 753.5a

RECEIPT NUMBER: 39-01122017-008
STATE CLEARINGHOUSE NUMBER (If applicable)

SEE INSTRUCTIONS ON REVERSE. TYPE OR PRINT CLEARLY.

LEAD AGENCY SAN JOAQUIN COUNTY GENERAL SERVICES	LEAD AGENCY EMAIL	DATE 01/12/2017
COUNTY/STATE AGENCY OF FILING SAN JOAQUIN	DOCUMENT NUMBER 39-01122017-008	
PROJECT TITLE SAN JOAQUIN COUNTY DETENTION AND PROGRAM FACILITY		
PROJECT APPLICANT NAME SAN JOAQUIN COUNTY GENERAL SERVICES	PROJECT APPLICANT EMAIL	PHONE NUMBER (209) 468-3664
PROJECT APPLICANT ADDRESS 44 N SAN JOAQUIN ST STE 590	CITY STOCKTON	STATE CA
		ZIP CODE 95202

PROJECT APPLICANT (Check appropriate box)

Local Public Agency     School District     Other Special District     State Agency     Private Entity

CHECK APPLICABLE FEES:

- Environmental Impact Report (EIR) \$3,078.25 \$ \_\_\_\_\_
  - Mitigated/Negative Declaration (MND)(ND) \$2,216.25 \$ \_\_\_\_\_
  - Certified Regulatory Program document (CRP) \$1,046.50 \$ \_\_\_\_\_
  - Exempt from fee
    - Notice of Exemption (attach)
    - CDFW No Effect Determination (attach)
  - Fee previously paid (attach previously issued cash receipt copy)
- 
- Water Right Application or Petition Fee (State Water Resources Control Board only) \$850.00 \$ \_\_\_\_\_
  - County documentary handling fee \$ \_\_\_\_\_ \$50.00
  - Other \$ \_\_\_\_\_

PAYMENT METHOD:

Cash     Credit     Check     Other

TOTAL RECEIVED \$ \_\_\_\_\_ \$50.00

SIGNATURE 	AGENCY OF FILING PRINTED NAME AND TITLE Rosette Keopadubsy, Deputy
---------------	---

San Joaquin County Recorders  
 Steve J. Bestolardes  
 44 N. San Joaquin Street, Room 280  
 Stockton, Ca 95202  
 Receipt: 0831214-C1

Receipt corrected 1/12/17 10:42 AM by rosettek  
 C1 - page count

Product Name	Extended
FISH CLERK CLERK FISH AND GAME FILINGS	\$50.00
# Pages	4
Document #	39-01122017-008
Clerk Filing Fee	\$50.00
<b>Total</b>	<b>\$50.00</b>

Tender (On Account (Charge or Prepay))	\$50.00
Account# SJFM.	
Account SAN JOAQUIN FACILITIES	
Name MANAGEMENT DIV	
Balance \$50.00	
Comments: Project #3580	

Thank You!  
 1/12/17 10:41 AM rosettek

